

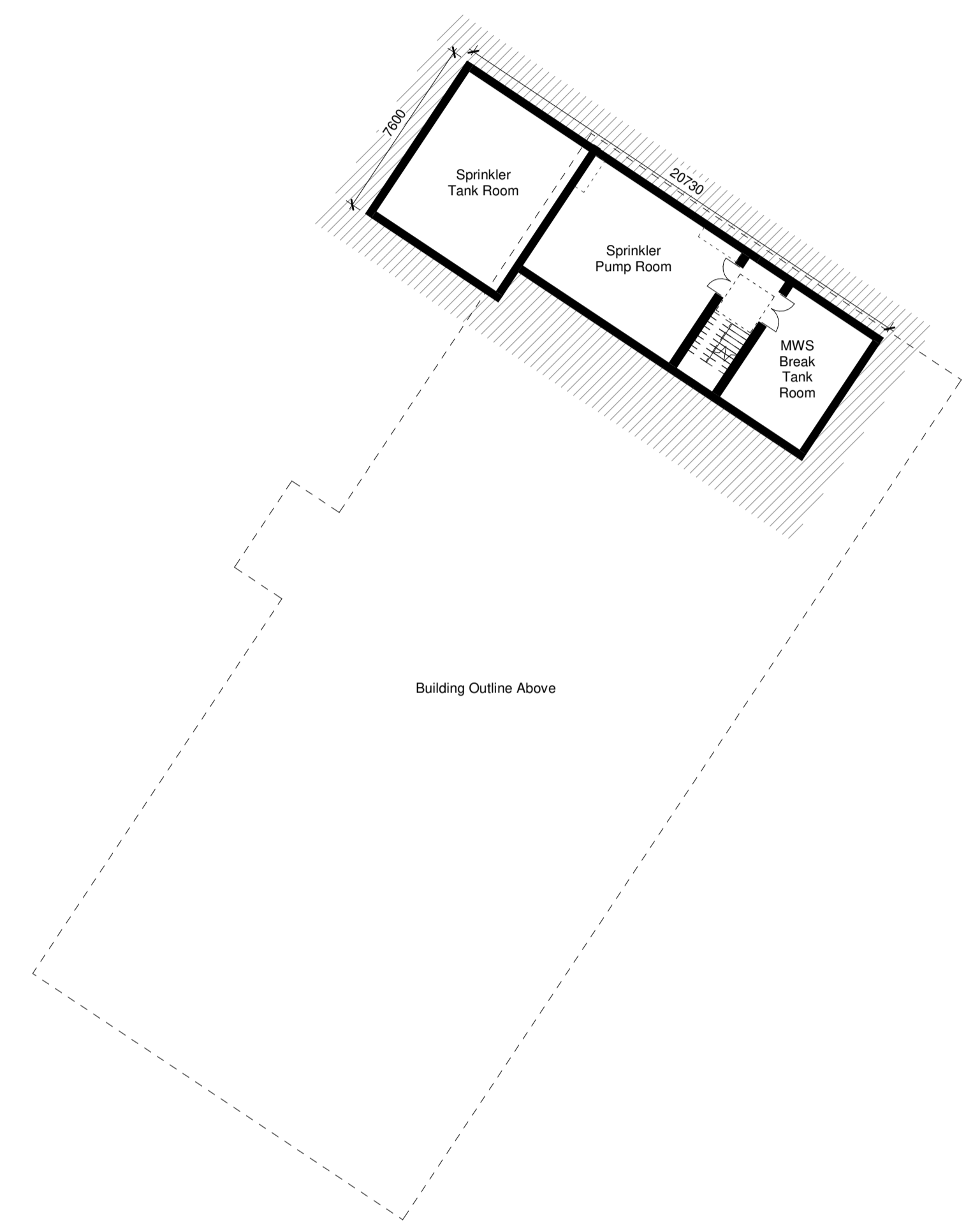

1 Stonetown Terrace Ground Floor Plan  
1 : 200



2 Basement Plant Level (Block 3A)  
1 : 200

Revision	Drawn	Checked	Date	No.
STAGE 2A2 - PLANNING ISSUE	AL	KH	07/10/25	P01
DRAFT - PLANNING RFI RESPONSE - PAS/CAS AREAS ADDED	TS	KH	08/05/26	P02

**BMCEA Notes:**  
All levels and dimensions on this drawing are to be checked on site. No dimensions are to be scaled. Any discrepancies on this drawing are to be reported to the architect. This drawing is the copyright of Bucholz McEvoy Architects Ltd and may not be copied, altered, or reproduced in any form or passed to a third party without license or written consent. All work to comply with the Building Regulations.

This drawing is to be read in conjunction with all other application documentation and information as issued.

This is not a construction drawing, it is unsuitable for the purpose of construction and must on no account be used as such.

Areas have been prepared for our client Limerick Twenty Thirty Strategic Development DAC are approximate only and have been measured from .dwg survey information drawings received on 11.09.2020 GEODATA-Measured Buildings Survey (Blocks 1-14). Net Internal Areas are annotated and approximate only. Construction tolerances, workmanship and design by others may affect stated areas.

- Legend**
- 1B1P
  - 1B2P
  - 2B3P
  - 2B4P
  - 3B5P

Note: Refer to upper level block plans for typical dimensions.  
Note: Refer to landscape architect's drawings for further details on proposed site levels and landscape treatment.

- KEY**
- PHASE II APPLICATION BOUNDARY
  - COMMUNAL AMENITY SPACE
  - SPOT HEIGHT
  - PRIVATE AMENITY SPACE FOR TOWNHOUSES

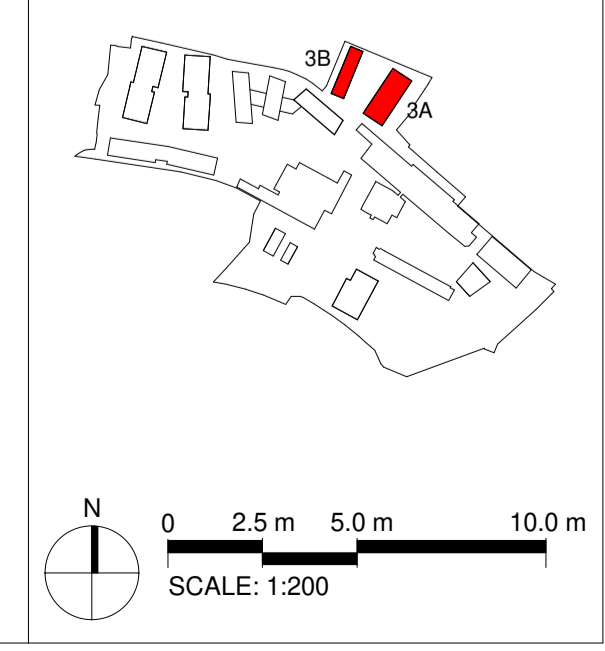

**STAGE 2A2**

drawing **Stonetown Terrace Ground Floor Plan – Proposed**

drawing no. **CRQMP-BMEA-3X-00-DR-AA-2020**

project <b>Cleeves Riverside Quarter Masterplan</b>	scale 1:200 @ A1	drawn LV/AL/TS	project no. CRQMP
client <b>Limerick Twenty Thirty</b>	date Oct. 2025	checked KH	revision P02

**bucholzmcEvoyARCHITECTS**

UNIT C MOUNTPLEASANT BUSINESS CENTRE UPPER MOUNTPLEASANT AVENUE DUBLIN 6 IRELAND  
T +353 1 496 6340 F +353 1 496 6341 INFO@BMCEA.COM WWW.BMCEA.COM