



Comhairle Cathrach  
& Contae **Luimnigh**

**Limerick City**  
& County Council

2<sup>nd</sup> April, 2026

**To: The Cathaoirleach and each Member of the Municipal District of Cappamore  
Kilmallock.**

**Proposed Disposal of Land at Killeely, Co Limerick, by way of a 30-year lease, to Cashel  
and Emly Diocesan Trust Company Limited by Guarantee.**



### **1. Introduction**

It is intended that the following proposed disposal of 0.6295 Acres (0.2547 Hectares) of land, by way of a 30-year lease, to Cashel and Emly Diocesan Trust Company Limited by Guarantee will be included on the Agenda for the May Full Council Meeting.

### **2. History of Property**

Cashel and Emly Diocesan Trust Company Limited by Guarantee are requesting lands in the village of Killeely to be leased to them for burial ground purposes. There are two sites for leasing, delineated A & B on the attached map.

Site A is an existing Community Millennium Graveyard, which had a lease that is now lapsed. Site B is proposed for new Community Ashes Graveyard.

Planning for the Ashes Graveyard will be progressed by the local community group.

The former lease on Site A included a Right of Way and this is also required to be included in the new lease (marked X -Y on attached map).

A covenant will be included in the lease that lands can only be used for burial ground purposes.

### **3. Executive Recommendation to Council.**

The proposal before the Members is to note the proposed disposal of 0.6295 Acres (0.2547 Hectares) of land at Killeely, Co Limerick, by way of a 30-year lease, to Cashel and Emly Diocesan Trust Company Limited by Guarantee in the sum of €1.

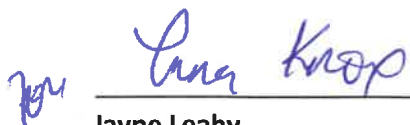

**Jayne Leahy**  
**Head of Property Services**  
**Economic, Tourism, Culture, Property & Corporate Buildings Directorate**  
**Limerick City & County Council**

Location Map – property marked in red

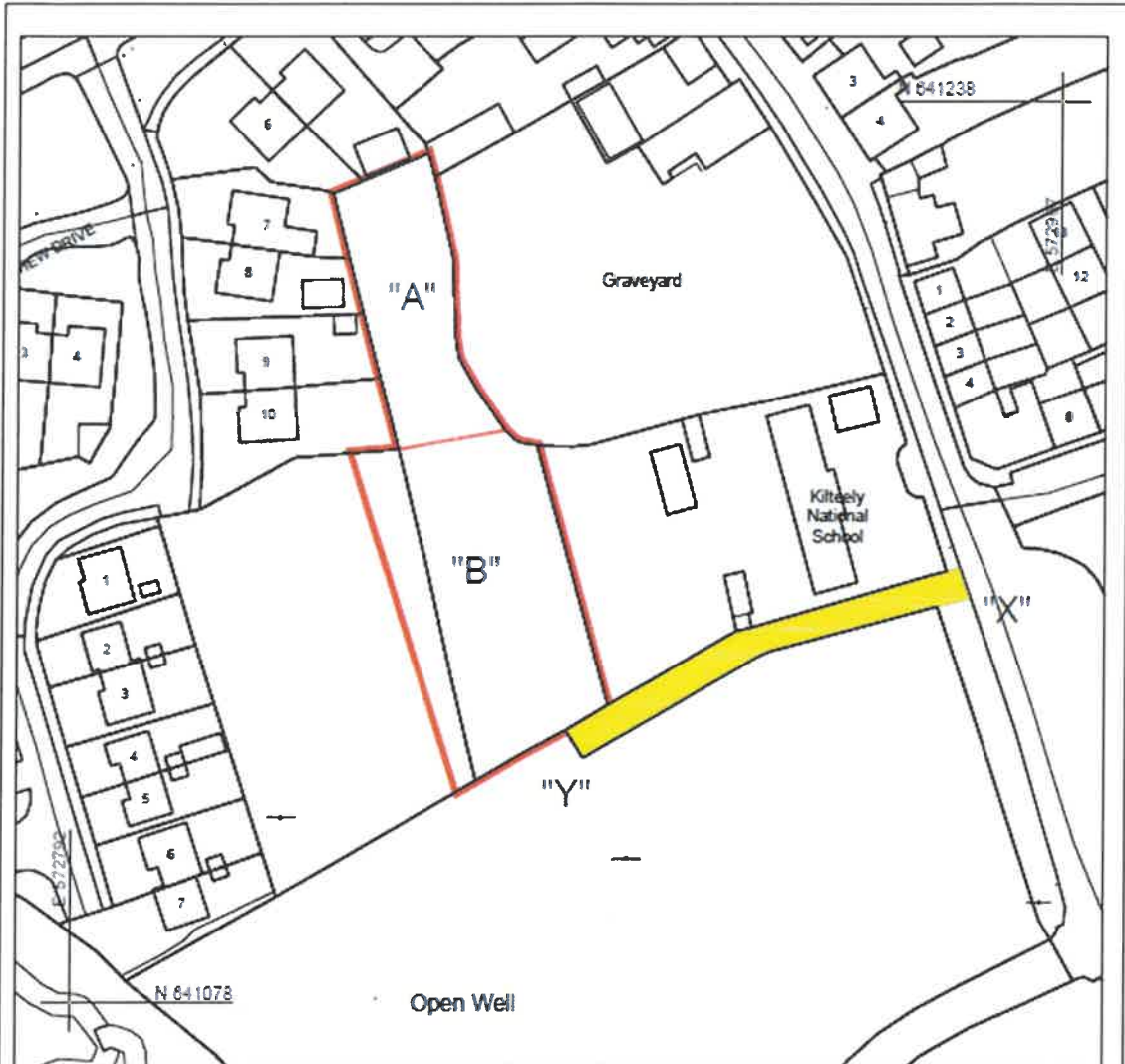

Sites for proposed Lease outlined in Red on the map.  
 Site A: Area = 0.2032 Acres/ 0.0822 Hectares/ 822.44 M<sup>2</sup>  
 Site B: Area = 0.4263 Acres/ 0.1725 Hectares/ 1725.21 M<sup>2</sup>



Area of Right of Way to be retained in favour of Cashel and Emly Diocesan Trust Company Ltd coloured in yellow and marked "X-Y".

National Mapping Division of Taisce Éireann. All rights reserved. Licence number CYAL5051180

© L:\FN\_Property\_01 (Property Services)\Property Drawings\1 Agreement Maps\AG5352 - A - Lease and Right of Way in Killeely, Limerick.dwg

**COPYRIGHT**  
 The design and details shown on this drawing are applicable to their project only and may not be reproduced in whole or in part or be used for any other project or purpose without the written permission of Limerick City and County Council with whose copyright notice.

**DO NOT SCALE** from this drawing. Use figured dimensions. Contractor to check all dimensions on site prior to commencement of works. Any discrepancies are to be referred to the ARCHITECT.

**REVISIONS**

NO	DATE	REV BY	DESCRIPTION

**Limerick City and County Council**  
 Property & Community Facilities  
 Barrow House, Michael St, Limerick

DATE: 22-12-2025  
 SCALE: 1:1000  
 DRAWN: BH  
 CHECKED: BH  
 FILE REF: .  
 AG TYPE: Lease

**PROJECT**  
 Lease and Right of Way to Cashel and Emly Diocesan Trust Company Ltd, Killeely, Limerick

**STACK**  
 Lease  
**DRAWING TITLE**  
 Lease and Right of Way to Cashel and Emly Diocesan Trust Company Ltd

**DRAWING NO:**  
 AG5352  
**SHEET NO:**  
 A4  
**REVISION:**  
 A