

# ACP *Architectural Conservation Professionals*



 **cabe**  
**builtenvironment**  
AWARDS 2024

**WINNER**

 **cabe**  
**builtenvironment**  
AWARDS 2024

## Building Record Reports

For

Cleeves Former Condensed Milk Factory  
Cleeves Riverside Quarter

**Client:** Limerick 2030



**Date:** 15<sup>th</sup> of October 2025

**Ireland:-** Grageen House, Cappanuke, Cappamore, Co Limerick, Ireland  
**Phone:** +353 (0) 61 574894, **Email:** [info@acpgroup.ie](mailto:info@acpgroup.ie)  
**Web:** [www.acpgroup.ie](http://www.acpgroup.ie)

**Singapore:-** 2 Venture Drive #19-18 Vision Exchange Singapore 608526  
**Phone:** +65 97168833, **Email:** [noel@acpgroup.sg](mailto:noel@acpgroup.sg)  
**Web:** [www.acpgroup.sg](http://www.acpgroup.sg)



## Building Record Reports

1. Building Record Report – Building 3 Engine House
2. Building Record Report – Building 5 Infiltration Gallery
3. Building Record Report – Building 7 Dairy Building & Linen Store
4. Building Record Report – Building 8 Workshop Building
5. Building Record Report – Building 9 Cheese Plant
6. Building Record Report – Building 10 Admin & Labs
7. Building Record Report – Building 14 Semi Detached Houses
8. Building Record Report – Building 16 Fernbank House

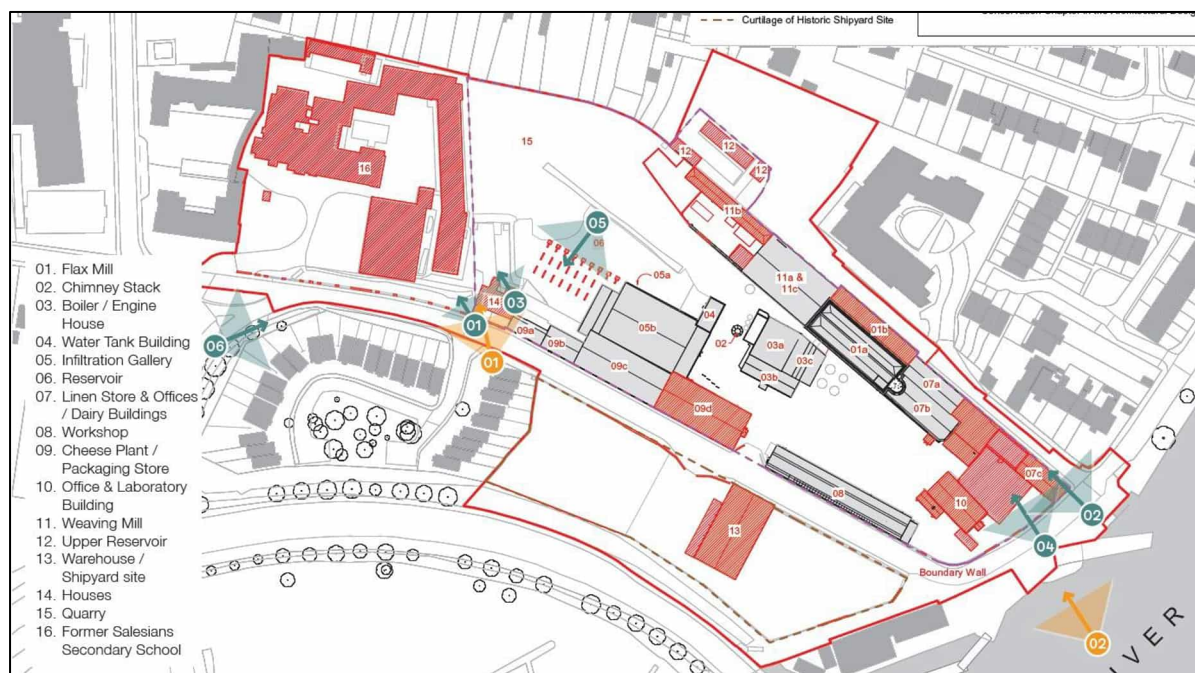

Cleves Riverside Quarter Building Location Map