

Comhairle Cathrach  
& Contae **Luimnigh**

**Limerick** City  
& County Council

7<sup>th</sup> April, 2025

**To: The Cathaoirleach and each Member of the Municipal District of Adare-Rathkeale**

**Proposed Disposal of 0.0147 acres (0.0059 ha) of land at Ballyadam, Askeaton, Co.  
Limerick to Stephen Foley**



### **1. Introduction**

It is intended that the following proposed disposal of 0.0147 acres (0.0059 ha) of land at Ballyadam, Askeaton, Co. Limerick (photo and map attached in this report) will be included on the Agenda for the May Full Council Meeting.

### **2. Description and Location of Property**

The subject land measuring 0.0147 acres (0.0059 ha) is located at Ballyadam, Askeaton, Co. Limerick.

### **3. History of the Property**

Stephen Foley acquired land at Ballyadam, Askeaton comprising folios LK2135F, LK9433F, and LK23849F in 2021. Stephen Foley (and his predecessors on title) have been in occupation of these lands and surrounding lands since at least 1974. A segment of land intersects the site where Mr Foley's dwelling house is built which is registered to Limerick City and County Council (LK67337F). It is believed that this is due to a mapping error. Mr Foley now wishes to regularise the mapping issue and acquire the land formally.

An inspection has been carried out on the property and the boundary is as per the map overleaf.

### **4. Executive Recommendation to Council**

The proposal before the Members is to note the proposed disposal of 0.0147 acres (0.0059 ha) of land at Ballyadam, Askeaton, Co. Limerick to Stephen Foley for a consideration of €1. Mr Foley to discharge all legal and other costs incurred by Limerick City and County Council.

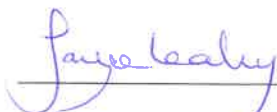

**Jayne Leahy,**  
**Head of Property Management,**  
**Rural, Community, Culture & Tourism Development Directorate,**  
**Limerick City & County Council.**

## Appendix

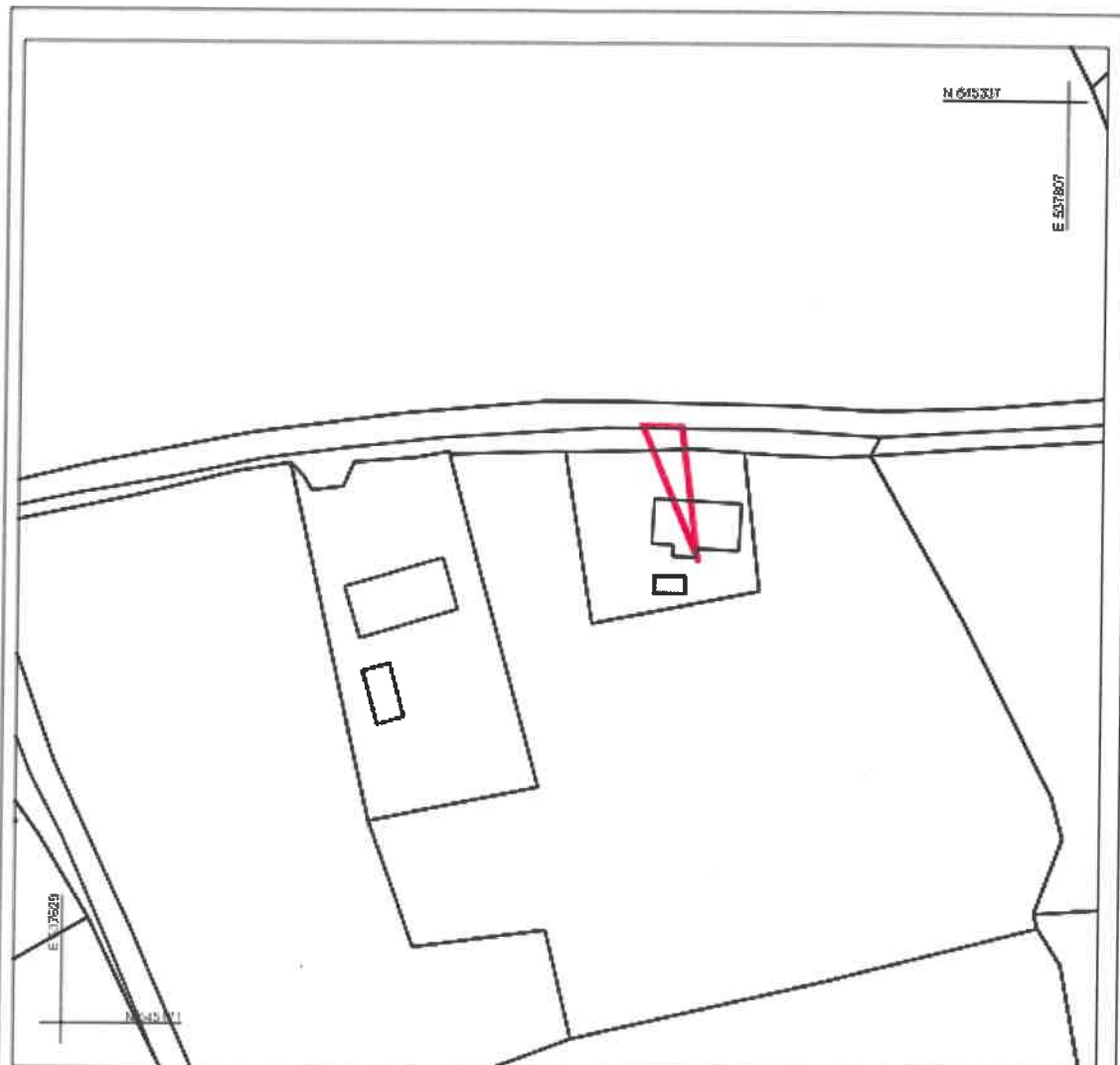

Site for proposed disposal outlined **In Red** on the map.  
Area: 0,0147 Acres/ 0,0059 Hectares/ 59.89 M<sup>2</sup>.

Land of Folio LK67337F.



National Mapping Division of Taoise Éireann . All rights reserved. Licence number CYAL50440417

L:\FN\_Property\_01 (Property Services)\Property Drawings\1 Agreement Maps\AG5293 - 0 - Disposal of Land Ballyadam, Askeaton, Co Limerick.dwg

**COPYRIGHT:**  
The design and details shown on this drawing are applicable to this project only and may not be reproduced in whole or in part or be used for any other project or purpose without the written permission of the Limerick City and County Council or the copyright holder.

**DO NOT SCALE:** Use the dimensions. Check all dimensions in the plan to confirm accuracy of work. Any discrepancies are to be referred to the ARCHITECT.

### REVISIONS

DATE	REV.	BY	CH.	DESCRIPTION

**Limerick City and County Council**  
Property & Community Facilities  
Barrow House, Michael St, Limerick

DATE: 01-04-2025

SCALE: 1:1000

DRAWN: BB

CHECKED: MS

FILE REF: 5.2.519

AG TYPE: Disposal

**PROJECT:**  
Disposal of Land at Ballyadam,  
Askeaton, Co. Limerick

**STAGE:**  
Disposal

**DRAWING TITLE:**  
Land Transfer Mapping

DRAWING NO:

AG5293

SHEET NO:

A4

REVISIONS

-