



Comhairle Cathrach
& Contae **Luimnigh**

Limerick City
& County Council

27th November, 2023

To: The Cathaoirleach and each Member of the Cappamore-Kilmallock District

Proposed Disposal of 0.3 acres (0.123 Hectares) of Land at Turagh Crescent, Cappamore, Co. Limerick to Clúid Housing



1. Introduction

It is intended that the following proposed disposal of a 0.3 acres (0.123 Hectares) to Clúid Housing, by way of a Section 183 Disposal Notice, will be included on the Agenda for the January Full Council Meeting in 2024.

Please refer to Appendix 1 for outline of the area for disposal to Cluid.

2. Description and Location of Property

The Council originally purchased the land bank at Turagh Crescent, Cappamore, Co. Limerick consisting of 6.05 acre (2.45 hectares) on the 16th of December 1999 at a cost of £200,000.00. The acquisition was funded by the Department of Housing, Local Government and Heritage. A portion of this site was transferred to the Housing Agency, in the intervening period, under the Land Aggregation Scheme which facilitated the proposal for 15 units by Clúid (17 less 2).

3. Planning

Clúid Housing were granted full planning for 17 units at Turagh Crescent, Cappamore, Co. Limerick under ref. 22/1352 for the development of social housing supported by Capital Advance Leasing Facility (CALF) loan. 0.3 acres of the land that is to be developed for 2 of the units, and has planning permission, is in the ownership of Limerick City and County Council.

It is proposed to dispose of the total area of 0.3 acres/0.123 hectares to Cluid Housing AHB which will facilitate 2 units of social housing units. Please refer to Appendix 2 for site layout map of the 17-unit scheme.

4. Recommendation

The Proposal before the members is to note the proposed disposal of 0.3 acres (0.123 hectares) of land at Turagh Crescent, Cappamore, Co. Limerick to Clúid Housing in the sum of €254 (two hundred and fifty-four euro - €127 x 2 units). Clúid Housing shall be liable for legal and other costs arising from the disposal of this site subject to the covenants and conditions arising in the sales contract.

Recommended by:



Sarah Newell
Senior Executive Officer
Housing Directorate

Endorsed by:



Caroline Curley
Director of Service
Housing Directorate

Appendix 1 – AG5188

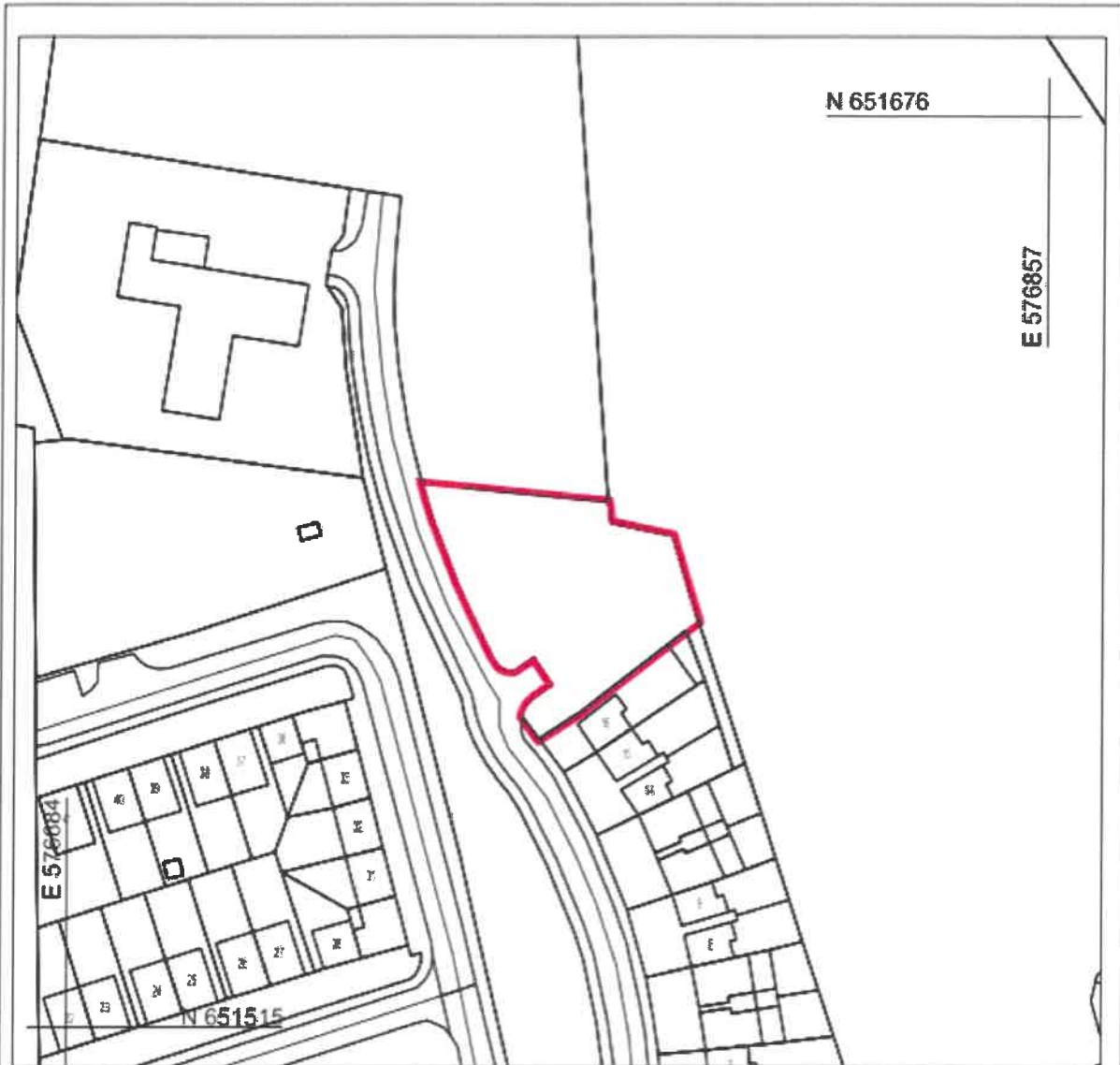

Note: Site for proposed disposal at Turagh Crescent Cappamore highlighted in Red on the map, these lands form part of Limerick City and County Council's Folio LK53076F. Total approx. area of lands for disposal = 0.3 Acres/0.124 Hectares



©Ordnance Survey Ireland/Govt. of Ireland 2021/OSI_NMA_141

Y:\0-Item-1\Drawings Repository\N_Property_01 (Property Services)\Property Drawings\1 Agreement Maps\AG5188 - 0 - Disposal of Land at Turagh Crescent Cappamore to Cluid Housing.dwg

<p>COPYRIGHT: The design and details shown on this drawing are applicable to this project only and may not be reproduced in whole or in part or be used for any other project or purpose without the written permission of Limerick City and County Council where copyright resides.</p> <p>DO NOT SCALE from this drawing. Use the printed dimensions. Contractor to check all dimensions on site prior to commencement of work. Any discrepancies are to be referred to the ARCHITECT.</p>	<p>REVISIONS</p> <table border="1"> <thead> <tr> <th>DATE</th> <th>REV. BY</th> <th>CH.</th> <th>DESCRIPTION</th> </tr> </thead> <tbody> <tr> <td> </td> <td> </td> <td> </td> <td> </td> </tr> </tbody> </table>		DATE	REV. BY	CH.	DESCRIPTION					<p>Limerick City and County Council Property & Community Facilities Barrow House, Michael St, Limerick</p> <p>DATE: 08/11/2023 SCALE: 1:1000 DRAWN: SB CHECKED: FILE REF: NA AG TYPE: Disposal</p>		<p>PROJECT: Land Disposal to Cluid Housing</p> <p>STAGE: Transfer/Registration</p> <p>DRAWING TITLE: Proposed Disposal at Turagh Crescent Cappamore</p>	
	DATE	REV. BY	CH.	DESCRIPTION										
<p>DRAWING NO: AG5188</p>	<p>SHEET SIZE: A4</p>	<p>REVISIONS: 0</p>												

Appendix 2 – Site layout map of the 17 – unit scheme



1 1/500

CIFA C.J. Falconer ASSOCIATES

Project Name	17-Unit Scheme
Client	Mr. & Mrs. J. Falconer
Address	17-Unit Scheme, 17-Unit Scheme, 17-Unit Scheme
Date	17-Unit Scheme, 17-Unit Scheme, 17-Unit Scheme
Author	Mr. & Mrs. J. Falconer
Scale	1:500
North Arrow	North Arrow