

**COMHAIRLE CATHRACH AGUS CONTAE LUIMNIGH  
LIMERICK CITY AND COUNTY COUNCIL**

**Merchant's Quay,  
Limerick.**

**8<sup>th</sup> September 2023**

**TO: THE MAYOR AND EACH MEMBER OF LIMERICK CITY AND COUNTY COUNCIL**

**A Chomhairleoir, a chara,**

Notice is hereby given, in accordance with the provisions of Section 183 of the Local Government Act, 2001 (as amended) and Section 211 of the Planning and Development Act, 2000 (as amended), of the intention of the Council to dispose of the property described hereunder on the conditions specified.

Land:	Gardenfield South, Dromcollogher, Co. Limerick.
Person from whom acquired:	Peter & Josephine Heffernan
Person to whom the land is to be disposed:	Josephine Heffernan
Consideration:	€195.42
Covenants / Conditions / Agreements:	The disposal will be by way of Deed of Conveyance of the freehold interest of Limerick City & County Council in the property.

The Council shall resolve at a Meeting held after the expiration of ten days after the day on which this Notice is sent or delivered, that the disposal:

- (1) Shall not be carried out, or
- (2) Shall be carried out in accordance with terms specified in the Resolution.

If the Council does not pass a Resolution to either effect, the disposal may be carried out in accordance with the terms of this Notice.

**Is mise le meas,**



**STEPHANE DUCLOT  
DIRECTOR OF SERVICE**

# LIMERICK COUNTY COUNCIL

COTTAGE PURCHASE SCHEME UNDER THE LABOURS' ACT 1936 AND  
HOUSING ACT 1966

Cottage No. *N 908* Folio No. .... Tenant *PETER + Josephine HEFFERNAN*

Townland of: *GARDENFIELD SOUTH* O.S. No. *54/3* County of Limerick

Scale *1/2500* Area of Plot *1.09* A. — R. — P

I CERTIFY THAT THIS IS A TRUE MAP OF THE PLOT  
HEREINBEFORE DESCRIBED.

SIGNED *Thomas Torpy*

DATE *8th August 1978*

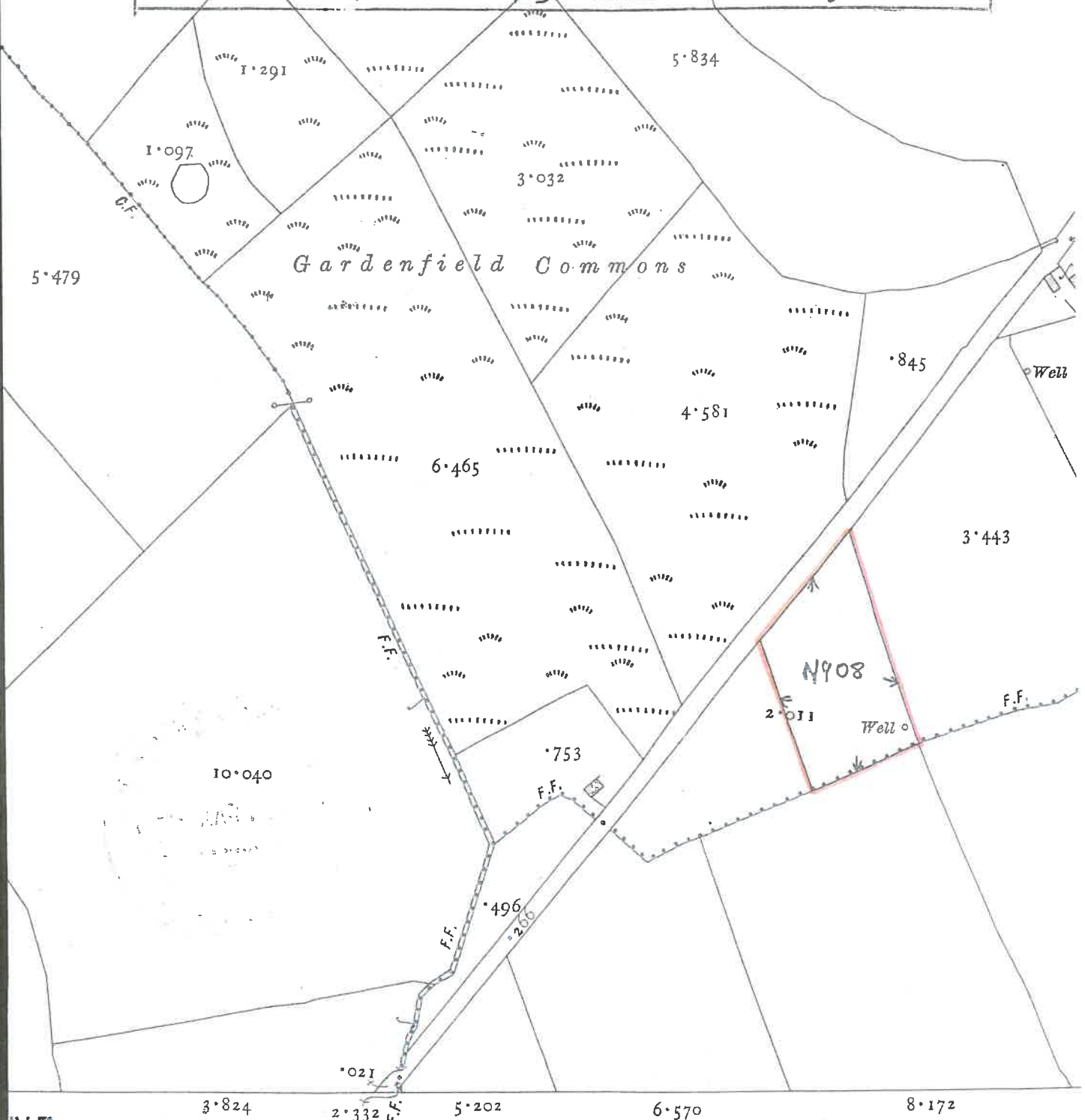

IV.7

Survey Office, Phoenix Park, Dublin, 1921.

which is 21 Feet below a mark on the base of Poolbeg Lighthouse.

Links 100 9



> Back

Folio Number	LK5034L
Title Level	Leasehold
Plan Number	3
Property Number	1
Area of selected plans	0.43 hectares.
Number of Plans on this folio:	1
Address	Gardenfield, Dromcollogher, Co. Limerick, P56 D212
View Folio PDF	
Request Certified Copy	

\*PSA Boundaries and Plan Area are not conclusive. See Section 62(2) of Registration of Title Act 2006 and Rule 8(2) of the Land Registration Rules 2012.

Print Current View

Help