



Comhairle Cathrach
& Contae **Luimnigh**

Limerick City
& County Council

Pleanáil, Comhshaol agus Cruthú Áite
Comhairle Cathrach agus Contae Luimnigh
Bothar Thuar an Daill
Tuar an Daill, Luimneach
V94 WV78

Planning, Environment and Place-Making
Limerick City and County Council
Dooradoyle Road
Dooradoyle, Limerick
V94 WV78

30th December, 2022.

TO: The Cathaoirleach and Each Member of the Municipal District of Newcastle West

**RE: Taking in Charge of Estates
Declaration of Roads to be public roads.**

A Chomhairleoir, a chara,

It is proposed that the estate listed below be taken in charge by Limerick City and County Council.

Gleann Daire, Ardagh

In accordance with Section 180 of the Planning and Development Acts 2000 (as amended) and Section 11 of the Roads Act 1993 public notice was given of the intention of the Council to consider the matter, drawings of the estate were put on public display and submissions were invited from the public on the proposed take-over of the estate and the declaration of the roads to be public roads.

No submissions were received

When taken in charge the council will incur an annual cost of €567.50 inclusive of VAT for the operation of the public lighting in this estate.

Your approval is requested for the taking-in-charge of the above mentioned estate in accordance with Section 180 of the Planning and Development Act 2000 (as amended) and Section 11 of the Roads Act 1993.

Is mise le meas,

Nuala O'Connell,
Senior Planner,
Planning, Environment and Place-Making

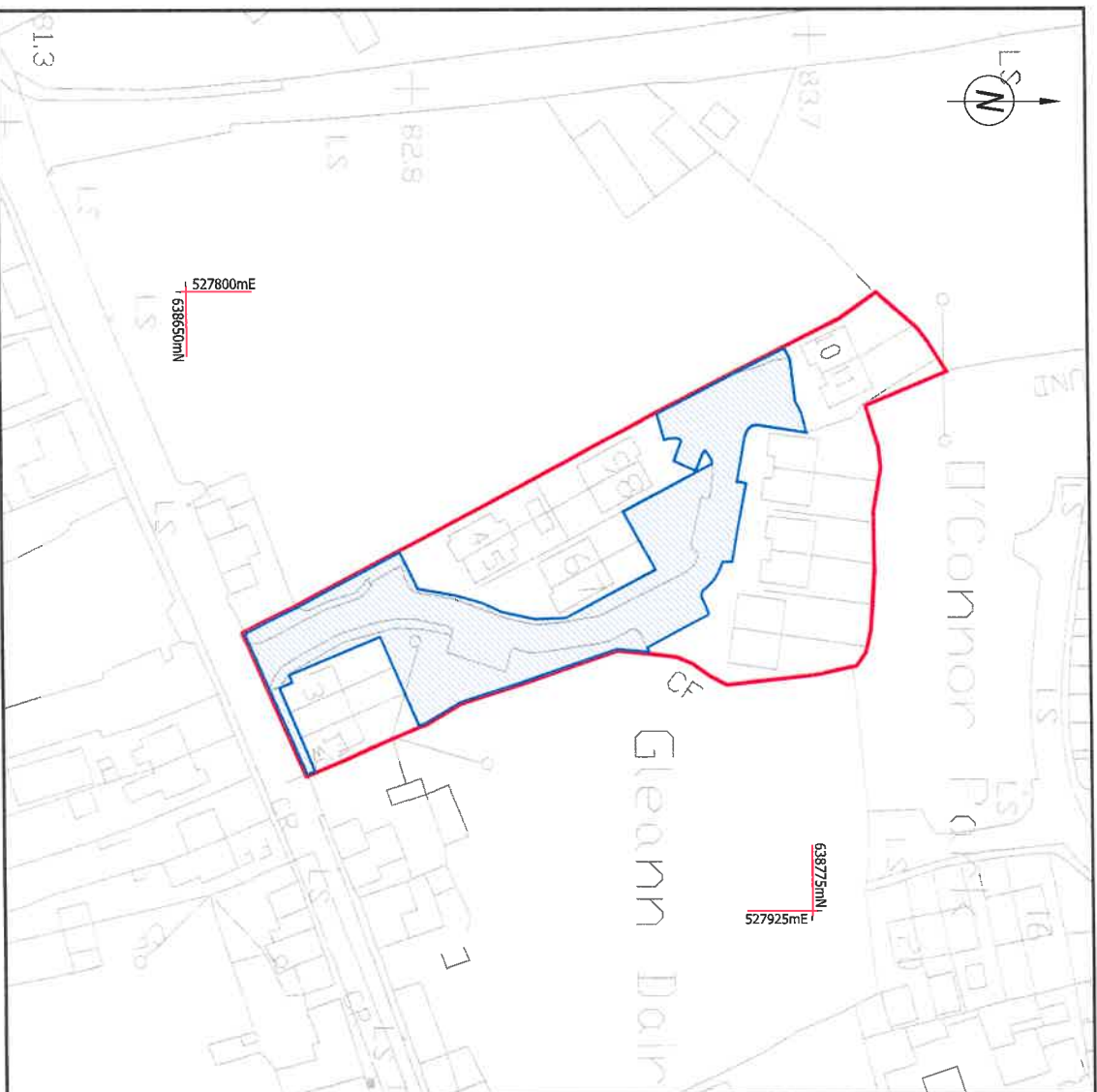

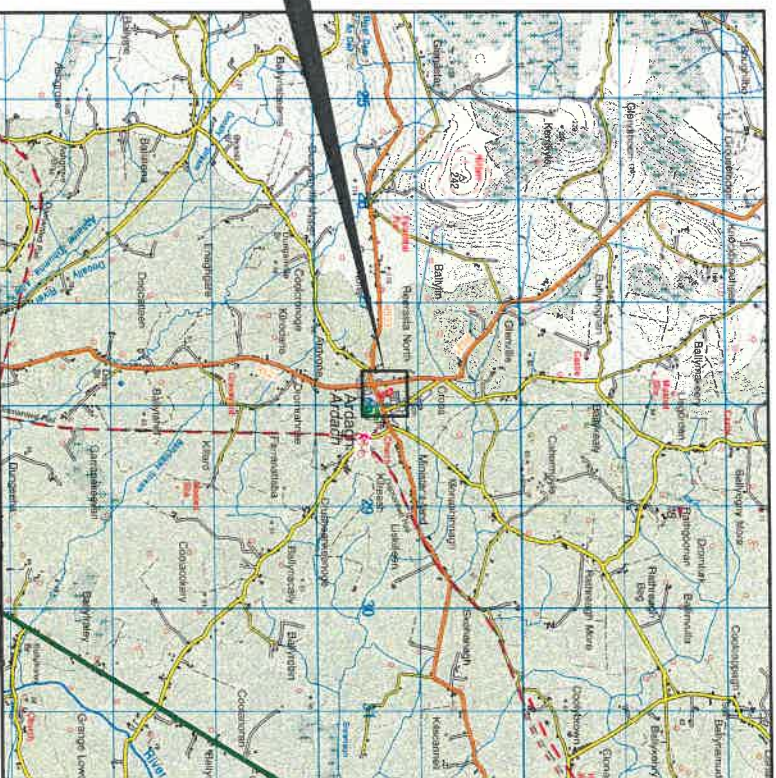

Site Location Map 1:1,000

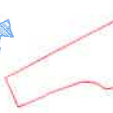

Site Location Map 1:50,000

Legend:

-  = Estate Bdy.
-  = Taking In Charge Bdy.

Notes:

- Coordinate System: Irish Transverse Mercator (ITM)
- This drawing is the property of Limerick City & County Council. It is a confidential document and must not be copied, used, or its content divulged without prior written consent.
- Ordnance Survey Ireland Licence No.2010/09/CCMA/Limerick City and County Council Copyright Government of Ireland.



Comhairle Cathrach
& Contae Lúimnigh
Limerick City
& County Council



LIMERICK CITY & COUNTY COUNCIL
Comhairle Cathrach & Contae Lúimnigh

PLANNING, ENVIRONMENT & PLACEMAKING
CITY HALL
MERCHANTS
DUVA O'CALLAGHAN, DIRECTOR OF SERVICES
COUNTY HALL
DOONAGRAVE
CO. LIMERICK
IR51 53 55000
Tel: 051 407100

PAPER SIZE

A3

Taking In Charge

'Gleann Daire'

Ardagh

Co. Limerick

Date: May 2022

Planning Ref.: P05/1141

TIC Ref.: 09/09

Drawn By: J.C.

Scale: AS SHOWN

Drawing No: 09/09-01