

COMHAIRLE CATHRACH AGUS CONTAE LUIMNIGH
LIMERICK CITY AND COUNTY COUNCIL

Merchant's Quay
Limerick

11th June 2021

TO/ THE MAYOR AND EACH MEMBER OF LIMERICK CITY AND COUNTY COUNCIL

A Chomhairleoir, a chara,

Notice is hereby given, in accordance with the provisions of Section 183 of the Local Government Act, 2001 (as amended) and Section 211 of the Planning and Development Act, 2000 (as amended), of the intention of the Council to dispose of the property described hereunder on the conditions specified.

Land:	0.024 Ha. at Rossfinch, Ballinahinch, Co. Tipperary
Person from whom acquired:	Reps of John G Ryan, Reps of Martin Ryan & James Ryan (Snr), c/o Sheila Ryan, Rossfinch, Ballinahinch, Newport, Co. Tipperary
Person to whom the land is to be disposed:	Martin Ryan, Ballinahinch, Co. Tipperary
Consideration:	Nil
Covenants, Conditions/Agreements	Martin Ryan to be responsible for the Council's reasonable legal costs Martin Ryan to indemnify Limerick City & County Council against all claims, liabilities of whatever nature in respect of any services on this site.

The Council shall resolve at a Meeting held after the expiration of ten days after the day on which this Notice is sent or delivered, that the disposal:

- (1) Shall not be carried out, or
- (2) Shall be carried out in accordance with the terms specified in the Resolution.

If the Council does not pass a Resolution to either effect, the disposal may be carried out in accordance with the terms of this Notice.

Is mise le meas



CHIEF EXECUTIVE

0000_12_00193

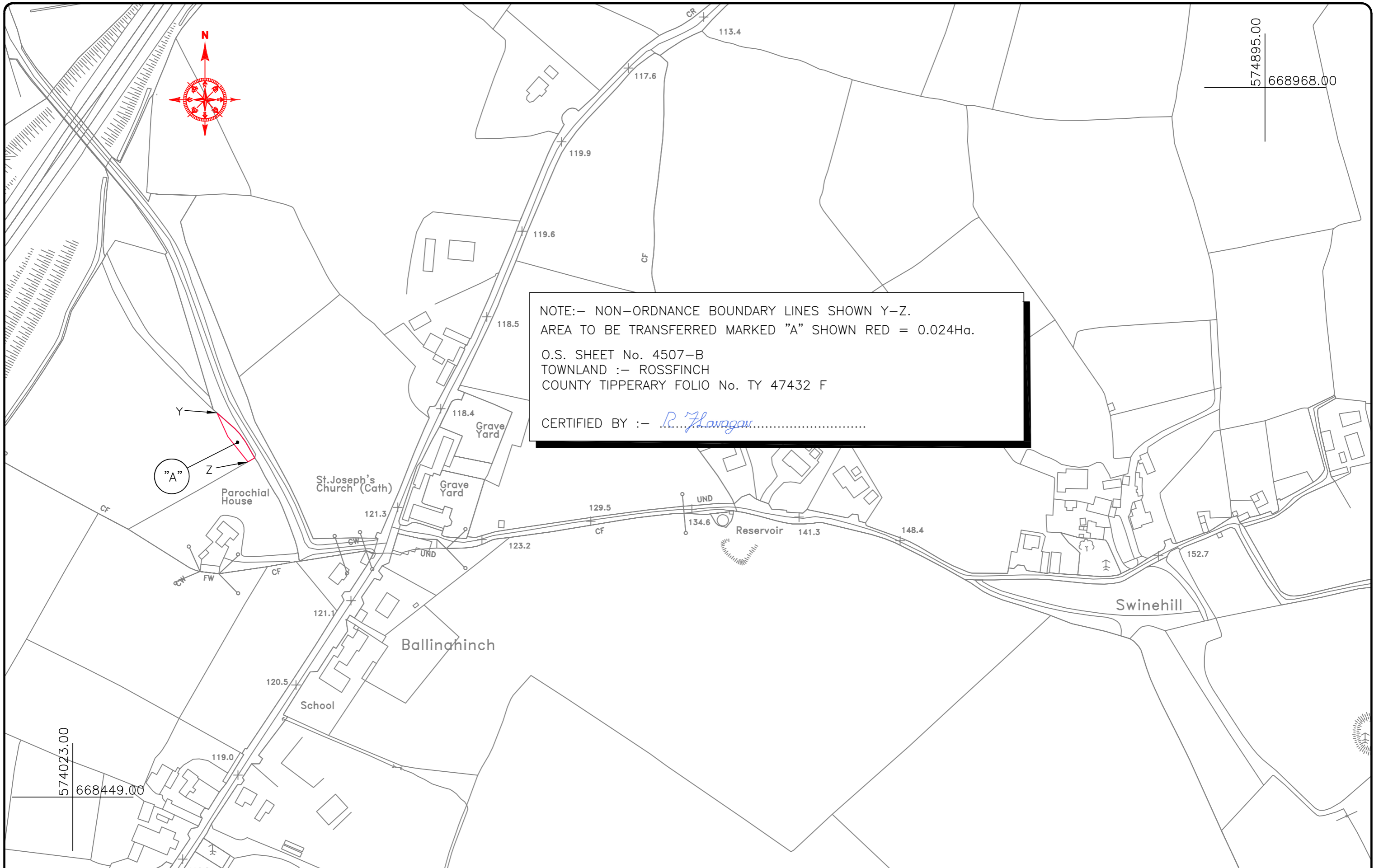

NOTE:- NON-ORDNANCE BOUNDARY LINES SHOWN Y-Z.
 AREA TO BE TRANSFERRED MARKED "A" SHOWN RED = 0.024Ha.
 O.S. SHEET No. 4507-B
 TOWNLAND :- ROSSFINCH
 COUNTY TIPPERARY FOLIO No. TY 47432 F
 CERTIFIED BY :- *R. Flanagan*



Comhairle Cathrach & Contae Luimnigh
 CORPORATE HEADQUARTERS,
 LIMERICK CITY AND COUNTY COUNCIL,
 MERCHANTS QUAY,
 LIMERICK,
 TEL: 353 81 556000

Limerick City & County Council

Mid West National Road Design Office
 MID WEST NATIONAL ROAD DESIGN OFFICE
 LASSANALTA HOUSE
 DOORADOYLE ROAD,
 LIMERICK
 Tel: 061 - 951000
 e-mail info@midwestroads.ie

NOTE:-
 1) THIS DRAWING IS THE PROPERTY OF LIMERICK CITY & COUNTY COUNCIL. IT IS A CONFIDENTIAL DOCUMENT AND MUST NOT BE COPIED, USED, OR ITS CONTENT DIVULGED WITHOUT PRIOR WRITTEN CONSENT.
 2) ALL LEVELS ARE REFERRED TO ORDNANCE SURVEY DATUM.
 3) DO NOT SCALE. USE FIGURED DIMENSIONS ONLY. IF IN DOUBT, ASK.
 4) ORDNANCE SURVEY IRELAND LICENCE No. 2021/09/CCMA/LIMERICK CITY & COUNTY COUNCIL. COPYRIGHT GOVERNMENT OF IRELAND.

Rev.	Description	By	Chk.	App.	Date
0	ISSUED FOR LAND DISPOSAL	R.F.	G.C.	T.F.	10.03.21
A	ISSUED FOR LAND DISPOSAL - GENERAL UPDATE	<i>R.F.</i>	<i>G.C.</i>	<i>T.F.</i>	08.06.21

Project: **N7 NENAGH TO LIMERICK HIGH QUALITY DUAL CARRIAGEWAY**

Title: **LAND TRANSFER FROM LIMERICK CITY & COUNTY COUNCIL TO MARTIN RYAN**

Designed: R.D.O.	R.F.	Stage: LAND DISP.	TII Project Ref. No:	Drawing No.:	Revision:
Drawn: <i>R.F.</i>	R.F.	Scale: 1:2500	LC/99/130	0000/12/0025	A
Checked: G.C.	G.C.	Date: 10.03.21			