



Comhairle Cathrach  
& Contae **Luimnigh**

**Limerick City**  
& County Council

## **Adare Rathkeale Municipal District**

### **District Engineer's Report**



## **Adare Rathkeale Municipal District Meeting**

**November 10th 2020**

## TABLE OF CONTENTS

	<b>Page</b>
1 Councillor Requested Reports	3
1.1 Fedamore Traffic Calming	
1.2 Banogue Traffic Calming Scheme	
1.3 Ballysteen Directional Signage	
1.4 Church Road Croom	
1.5 Blossom Hill Cross	
2 Schedule of MD Works	4
3 Village Updates	7
3.1 Foynes	
3.2 Croom	
3.3 Adare	
3.4 Rathkeale	
3.5 Ballingarry	
3.6 Askeaton	
3.7 Shanagolden	
3.8 Fedamore	
4 GMA Update	12
5 Update from Central Services	16
6 Update from Design and Delivery	16
7 Update from Housing Development	17
8 Update from Community Development on the Adare Fountain	18

## 1. Councillor Requested Reports

### 1.1 Fedamore Traffic Calming

An application has been made for a Low Cost Safety Scheme in Fedamore. This incorporates raised tables and driver feedback signs.

### 1.2 Banogue Traffic Calming Scheme

MWRDO have received TII Approval for the preferred tenderer and are currently in the process of awarding the contract.

### 1.3 Ballysteen Directional Signage

This signage has been ordered and will be erected in the coming weeks.

### 1.4 Church Road, Croom

A Speed survey will be carried out on this road in the coming weeks and, should the survey prove a warrant, traffic calming designs will be considered.

### 1.5 Blossom Hill Cross

Central Services are awaiting a meeting with the TII Road Safety Engineer in relation to lining at this junction.

## 2. Update on Schedule of MD Works

<b>ADARE RATHKEALE MUNICIPAL DISTRICT</b>				
<b>Road Works Schemes 2020</b>				
<b>Regional Roads</b>				
<b>Road Reconstruction</b>				
<b>Allocation € 786,601</b>				
<b>Road No.</b>	<b>Description</b>	<b>Length (m)</b>	<b>Total Cost €</b>	<b>Status</b>
R518	Rathkeale - Danahers Cross to Cois Deel	525	€254,000	Overlay has been completed, final works on the footpaths are currently underway
R518	Ballingarry - Rylands to Grotto	500	€400,334	Overlay has been completed, final works on the footpaths are currently underway.
R521	Shanagolden Main Street Jn	200	€50,000	In Progress
R516	Croom Main Street Jn	100	€20,000	

R521	Shroolane Trench Reinstatement	450	€32,262	Works Complete
R521	Corbally Bends	130	€30,005	Works Complete
<b>Total</b>		<b>1,905</b>	<b>€786,601</b>	

<b>Regional Roads Surface Dressing Allocation € 136,785</b>				
Road No.	Description	Length (m)	Total Cost €	Status
R521	Cosgraves Cross towards Kate Dalys-Section 1	1,200	€46,200	Works Complete
R523	Reens to Ardagh	1,930	€63,690	Works Complete
R512	Ballyneety to Manister Rd	815	€26,895	Works Complete
<b>Total</b>		<b>3,945</b>	<b>€136,785</b>	

<b>Local Roads Surface Dressing Allocation € 505,583</b>				
Road No.	Description	Length (m)	Total Cost €	Status
L1422	Samco Jn to Kilgrogan Jn	1,200	€29,700	Works Complete
L1423	Shauntraud Jn Carnane	800	€19,800	Works Completed
L1201	Askeaton to Moig RM	1200	€29,700	Works Completed
L6066	Bartholemews	2100	€47,250	Works Completed
L1221	Ballycullen to Askeaton	1200	€27,000	Works Complete
L1423	Capparoo to Monanooag RM	1395	€34,526	Works Complete
L1203	Callow Jn towards Cheps Cross	1300	€32,175	Works Complete
L1208	Lynchs Shop to Dollas	1,500	€40,500	Works Complete
L1408	Crecora Jn to Bawnacouma Jn	1,300	€32,175	Works Complete
L1408	Crecora to Shanacough Jn	980	€21,402	Works Complete
L1208	Ballingarry to Croom Road from R519 Jn to kilmacow X Part 2	2,077	€51,405	Works Complete
L1420	Caherass Jn Towards Adare	1,450	€39,150	Works Complete
L8004	Manister School to Mortgage	2,000	€31,500	Works Complete
L1416	N21 Banogue Jn towards Maigue Bridge	1,100	€27,225	Works Complete
L8003	Manister School to Kilcurly	1700	€42,075	Works Complete
<b>Total</b>		<b>21,302</b>	<b>€505,583</b>	

<b>Local Roads Road Reconstruction Allocation € 1,042,376</b>				
Road No.	Description	Length (m)	Total Cost €	Status
L12143	Rylands Estate	200	€42,759	Works Complete
L1227	Ballyhahill to Gaa Field Jn	1550	€125,550	Works Complete

L1227	Shanagolden to Cloonaclohesy Depot	1200	€108,000	Works Complete
L1423	Capparoe to Monanooag RI	760	€75,240	Works Complete
L8065	Shangrove	1166	€94,446	Works Complete
L8016	Ballymacscreedeen East	300	€41,177	Works Complete
L1418	Croom Concrete Road	1300	€117,000	Works Complete
L1421	Lisaleen Road From Lantern Lodge	1242	€130,638	Works Complete
L8606	Morenane to Liskennett	1200	€133,920	Works Complete
L6110	Fleanmore Cross to Four Cross Roads	874	€86,526.00	Works Complete
L1201	Askeaton to Moig RI	880	€87,120.00	Works Complete
<b>Total</b>		<b>10,672</b>	<b>€1,042,376</b>	

<b>Low Cost Safety Improvement Schemes (LCSI) Allocation €112,000</b>				
Road No.	Description	Length (m)	Total Cost €	Status
R521	Shanagolden main Street Jn		50,000	Ongoing
R511	Kellihers Cross on the R511		12,000	Complete
R516 / L1478	Croom Junction Improvements		50,000	Ongoing
<b>Total</b>			<b>€112,000</b>	

<b>Drainage Works Allocation € 200,000</b>				
Road No.	Description	Length (m)	Total Cost €	Status
R521	Corbally		60,000	Works completed
L6106	Loughill Middle Road		20,000	Complete
R523	Courtmatrix		50,000	First section now complete, estimated 3 weeks to complete other section.
L6114	Knockpatrick		20,000	Complete
R518	Danaghers Cross		50,000	Complete
<b>Total</b>			<b>€200,000</b>	

<b>Bridge Rehabilitation Allocation € 245,000</b>				
<b>Road No.</b>	<b>Description</b>	<b>Length (m)</b>	<b>Total Cost €</b>	<b>Status</b>
L6150	Ballingarry Bridge, Ballingarry		85,000	Awaiting Section 50 Approval from the OPW, Construction to be carried out in 2021.
L6119	Shanid Upper		50,000	Complete
L1406	Doneen Bridge Crecora		25,000	Complete
L12341	Glenbane West Cul De Sac		50,000	Inspection and Design works were delayed due to Covid 19 restrictions, works are now scheduled for 2021.
L60891	Mohernagh		10,000	Inspection and Design works were delayed due to Covid 19 restrictions, works are now scheduled for 2021.
L1239	Lisgordan Kilcolman		25,000	Works Complete
<b>Total</b>			<b>€245,000</b>	

### 3 Village Updates

#### 3.1 Foynes

##### Foynes Yacht Club

Works Commenced on the 17<sup>th</sup> of August, this was a Design and Build contract, the Contractor gave an additional price for the rock armouring, this was considered good value, approved by the OPW and consequently the entire spit of land is now protected. The works are now substantially complete, fencing and final topsoiling to be completed.

##### Marine Cove Culvert

Preliminary report received. Final documentation for tendering purposes is currently underway. The consultant is checking the final design against predicted storm surge tides prior to finalising documents.

##### Monument Hill Walkway

We have been advised that only one ORIS project will be accepted from the District this year, as this project conflicts with the Marine Cove Culvert, we will wait and apply when the Culvert works are complete.

#### 3.2 Croom

##### Croom Traffic Management Project



Extensive consultation has been held with Community and Business Interests in relation to the Croom Traffic Management Plan. The main points raised by these interests are:

1. Additional Parking in Town Centre Area required due to removal of parking at one side of the street.

*The Municipal District is currently surveying the areas adjacent to the old bank building and adjacent to the post office to design additional parking in these areas. An application has made to fund these from the Town and Village Renewal Scheme.*

2. 2 Hour parking required in the Town Centre Area  
*Byelaws have been drafted for this and will be advertised shortly. The adoption of these Bye Laws is a reserved function of the District Members.*
3. Disabled Parking Spaces required.  
*The final design includes Disabled Parking Spaces at the recommended rate of 1 in 20.*

### **Croom Distributor Road**

Works are progressing on the Croom Distributor road (see update from Design and Delivery)

### **3.3 Adare**

#### **Walkway Dunraven to the River Maigue**

A Usage Survey on this walkway was conducted recently, a copy of which is attached to this report. The average usage of this walkway was just under 60 a day prior to the works and was measured at just under 382 per day after the works, which was a 639.6% increase.

#### **Pope's Quay**

Solicitors for Limerick City and County Council are currently in negotiations with the Dunraven Estate to secure ownership of the lands required for this development.

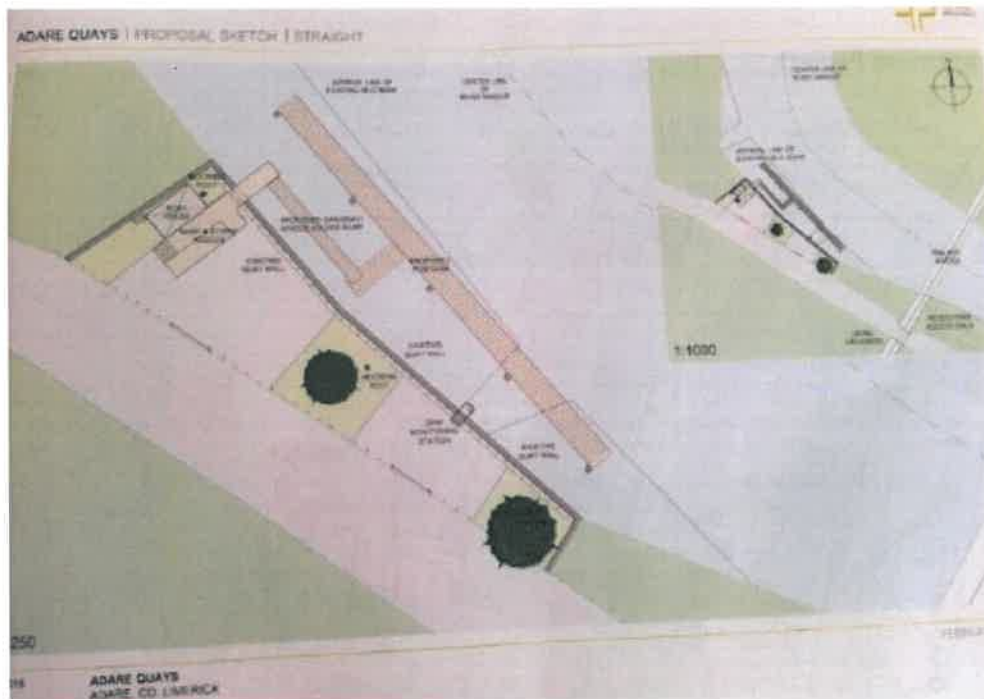

#### **Walkway to the GAA Pitch along the Blackabbey Road**

LCCC are currently in negotiations with a landowner which will provide the required lands for a substantial amount of this walkway.

#### **Contactless Water Font, Adare Heritage Centre**



A contactless water fountain is to be installed at the Adare Heritage Centre in the coming few weeks.

### 3.4 Rathkeale

#### Traffic Management

A meeting was held with the Gardaí in relation to required Traffic Management changes for Rathkeale. The following changes are proposed:

1. Introduction of a one way street on Pound Lane, in the direction away from Main Street.
2. Reversal of direction on the one way street between Bank Place and the Square.
3. Additional Double Yellow Lines at the upper end of Bank Place, Loading Bay at the Plumbing Supplies Shop.
4. Removal of single yellow lines throughout the town and replacement with Double Yellow Lines or marked parking spaces where space permits.
5. Introduction of double yellow lines on both sides of Lower Main Street between the junctions of New Road and New Line Road.

A drawing of the proposed changes has now been completed and will be circulated to the members for their input before implementation.

It was also agreed to close the Pepperd's Lane/ Main Street Junction to traffic from the 16<sup>th</sup> of November 2020 to the 15<sup>th</sup> of January 2021.

Discussions were held with the Physical Development Directorate earlier this year in relation to the required inner relief road through the Mart Site. Proposals in relation to this have now been sent to the Department of Transport.

#### Footpath links

An application has been made to the Town and Village Renewal Scheme to fund the refurbishment of the Riverside Walkway. This was successful and works will commence here in the coming weeks.

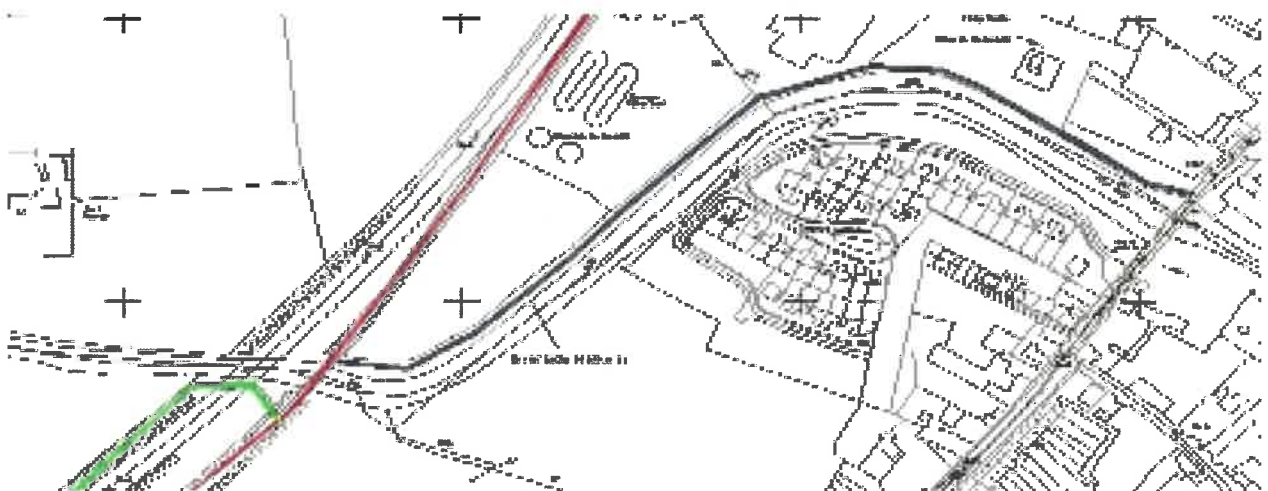

### **Rathkeale Library Pedestrian Crossing**

This pedestrian crossing is now complete. (awaiting white lining)

### **Ballywilliam Road and Footpath Scheme**

Kerbing, Drainage, Road reconstruction and Boundary Set Back Works are now complete. The footpaths will be completed before the end of the month.

### **Footpath link Library to Tadhg O'Connors**

Works on this are likely to proceed in the final quarter of the year.

### **Rathkeale Promotion**

Meetings have been held with Community Groups to promote a positive message about Rathkeale.

## **3.5 Ballingarry**

### **The Mall TVR Project**

The flood study on the Ballingarry stream has been received, final design on this area is now progressing.

### **Road and Footpath Reconstruction Rylanes to the Grotto**

Footpath work is completed in Rylanes, new footpaths have been installed to the church. This area is has now been resurfaced and the footpaths are due for completion this week.

### **Footpath link to Playground**

An application has been made under TVRS to connect the playground to the town centre. This was unsuccessful.

## **3.6 Askeaton**

### **Askeaton Town Centre TVR Project**

A Consultant has been appointed to conduct a Public Realm Study in Askeaton. The results from this study will determine the Town Centre Improvement works in the town. A Briefing Document for the appointment of Consultants to Design and Construct the Undergrounding of Services in Prominent areas of the town as well as enhancing Public Lighting is currently being drafted.

### Askeaton Riverside Looped Walk

An application will be made this year under ORIS to fund the River Walk extension to the Slí na Sláinte and to loop this to existing footpaths on the Quay.

### 3.7 Shanagolden

#### Shanagolden Low Cost Safety Works

Kerbing, Drainage and Boundary Setback Works are now largely complete and the footpaths are expected to be completed by the end of the month.



### 3.8 Fedamore

A meeting was held with representatives of Fedamore village in relation to a request for Traffic Calming in the village. This is currently being considered under the Low Cost Safety Scheme.

4 GMA Updates

<b>Cllr Richard /John O'Donoghue</b>	<b>€45,000</b>
<b>Nominations 2020</b>	
Ballyneety Community Development	2,000
Croom Park	6,000
Croom United	2,000
Scouts Den Croom	1,000
Granagh Ballingarry GAA	3,000
Pallaskenry Development Association	2,500
Chawkes Cross Road Improvements	3,000
Ballingarry Town Park	1,000
Ballingarry Development Association	1,000
Ballysteen Carnegie Library	3,000
Banogue GAA Community Field	2,000
Castle Rovers	2,000
Manor Fields, Adare	3,000
Granagh National School Parents Association	1,000
Croom GAA Club	1,000
Rathkeale Steering Committee	1,000
<b>TOTAL</b>	<b>34,500</b>

<b>Cllr Bridie Collins</b>	<b>€45,000</b>
<b>Nominations 2020</b>	
Creora Manister GAA	1,000
Abha Bhan Parish Park	2,000
Manor Fields Recreational facility	5,000
Tom Madigan community Field	3,000
Public Lighting Sli na Slainte Croagh	10,197
Public Fountain Restoration Adare	20,000
Rathkeale Tidy Towns	500
Pallaskenry Development Association	2,500
<b>TOTAL</b>	<b>44,197</b>

<b>ClIr Stephen Keary</b>	<b>€45,000</b>
<b>Nominations 2020</b>	
Convex Mirrors Foynes Corgrigg	130
Coolcappa Monument Cleaning	545
Ballinakill Development Group	3,500
<b>Pallaskenry Development Association</b>	<b>2,500</b>
Public Lighting Killaheen Reens 3	8,000
Ballysteen Carnegie Library	2,500
Gerald Griffins GAA Club	2,000
Ballingarry Community Park	2,000
Abha Bhan Parish Park Ltd	2,000
Signage & Road maintenance	1,100
Kilbradren Burial Ground	2,000
Public Road Signage	3,800
Rathkeale Community Council Welcome Centre Tourist Office	1,500
Rathkeale Community Council Community Shop	1,500
Coolcappagh Community Development	2,500
Foynes Aviation Museum	4,000
Rathkeale Steering Committee	1,000
Rathkeale Riverside Walkway	2,000
<b>TOTAL</b>	<b>42,575</b>

<b>ClIr Adam Teskey</b>	<b>€45,000</b>
<b>Nominations 2020</b>	
Shountrade AFC	10,000
Road Maintenance	10,000
Celtics Basketball	1,000
Askeaton Catholic Church	5,000
Coolcappagh Community Hall	3,000
Ballysteen Carnegie Library	3,000
Raheen Residents Associations	2,000
Cappagh Community Garden	500
Rathkeale Tidy Towns	1,000
Front Line Workers Rathkeale Community Council	500
Ballyhahill Development Association	3,000

Irish Palatine Museum	1,000
Rathkeale Steering Committee	1,000
Rathkeale Riverside Walk	2,000
Colaiste na Trocaire Rathkeale Lights	1,500
<b>TOTAL</b>	<b>44,500</b>

<b>Cllr Kevin Sheahan</b>	<b>€45,000</b>
<b>Nominations 2020</b>	
Deel Manor Residents	2,000
Askeaton St Pats Day Parade	1,000
Ballysteen National School Parents Association	2,000
Dernish Avenue Residents Assoc Foynes	1,500
Pallaskenry Development Association	2,500
Ballysteen Carnegie Library/ Ballysteen Development	3,000
St Marys Church /Fr Sean Long PP Askeaton	5,000
Askeaton Civic Trust	5,000
Askeaton Tennis Club	4,000
Abha Bhan Parish Park Ltd	2,000
Askeaton GAA	4,000
Kilbraden Burial Ground	2,000
Gerald Griffins Resource Centre	2,000
Tennis Club Askeaton	2,000
Foynes Community Council	1,000
Rathkeale Community Council	1,000
Askeaton/Ballysteen GAA Club	1,000
Lime Kiln restoration, Loughill	1,000
<b>TOTAL</b>	<b>42,000</b>

<b>ClIr Emmett O'Brien</b>	<b>€45,000</b>
<b>Nominations 2020</b>	
Pallaskenry Community Development Association	2,500
Ballysteen Carnegie Library	3,000
Ballyvareen Estate Kildimo	1,170
Pallaskenry Scout Troup	2,500
Kildimo Pallskenry GAA	5,000
Ringmoylan Security Gate	2,000
Ballysteen Parents Association	2,000
Kilcornan NS	2,500
Pallaskenry NS	2,500
Kildimo NS	2,500
Speed Ramps Refurbishment Ballyvareen Kildimo	4,000
Picnic Benches Ringmoylan	2,000
Manor Fields Adare	3,000
Cilluragh Burial Ground	4,000
Footpath Repair Pallaskenry	4,000
Kilcornan Burial Ground	1,500
<b>TOTAL</b>	<b>44,170</b>

## **5 Update from Central Services**

Grass and Hedge cutting on National Roads commenced 12<sup>th</sup> October 2020. This is the 3<sup>rd</sup> and final cut of the year. This is largely complete, with some outstanding works on the N20.

Overlay works have been completed in Ballingarry, Rathkeale-Ballywilliam, Kinscannel Bends and Croom Concrete Junction as part of this year's overlays contract.

## **6 Update from Design and Delivery**

**There was no update from Design and Delivery, last month's update was as follows:**

### **Croom Distributor Road**

The contractor is progressing well with the road project and the road is at capping level with kerbing and footpaths to commence in mid-October 2020. The Council is working closely with Limerick Clare Education Training Board to have road access available when Colaiste Chiarain is complete. The current date for completion of the school is 18<sup>th</sup> December 2020 with students to move into the new school immediately in the new year. The road project is scheduled to have the section of road from old Limerick road to new school open on 18<sup>th</sup> December 2020.

### **Kildimo**

The landowner has agreed the land take, monies and accommodation works but his solicitor has not engaged with Council solicitor to transfer the lands.



## 7 Update from Housing Development

Housing Development produce a Housing Newsletter Monthly which Councillors have received.

Relevant extracts from this report for Adare Rathkeale are as follows:

VACANT HOUSES- IHOUSE REPORT- OCTOBER						
	Allocated	Minor Repairs Cat 1&2	Major Refurbs Cat 3&4	Available for letting	Vacant Other	Total
<b>ADARE RATHKEALE</b>	7	5	5	0	3	<b>20</b>

HOUSE RETURNS-SEPTEMBER		
Keys In and Out		
	House Returns	Allocations
<b>ADARE RATHKEALE</b>	2	2

MONTHLY RETURNS FORECAST	November	December	January	February	Date TBC	Total
<b>ADARE RATHKEALE</b>	3	0	0	0	10	<b>13</b>

**8 Update from Community Development on the Adare Fountain**

Report Attached.

## **Adare Survey Part 2**

**Thursday 15<sup>th</sup> Friday 16<sup>th</sup> and Saturday 17<sup>th</sup> of October 2020**

The purpose of the survey was to measure the number of parked cars and the amount of pedestrian traffic on the route between the village of Adare the entry point of the river Maigue walk, which is located between the entrance to St Nicholas School and the riverbank and then to measure the same traffic after the upgrade to the walking route was completed.

The first part of this survey was carried out over three days in February 2020 pre-commencement of works on new footpath and also pre Covid-19 lockdowns and the second part was carried out in October 2020 just prior Ireland moving into Phase 5 of COVID-19 restrictions (the second lockdown)

At the time of the first survey there were cars parked along the route both outside the goods entrance of the Dunraven Arms hotel and along the roadside leading up to St Nicholas School and in the second survey the new footpath is in place and there is no parking along the route and during the survey time there were absolutely no cars parked there at any time.

There was another change which is that as part of COVID-19 restrictions foot traffic going from the village to the river walk towards Limerick was discouraged to enable a one-way walking system around the river route and out onto the new foot part beside the School.

In the first survey there was an even amount of pedestrian traffic in both directions with a considerable number of elderly walkers arriving by car to take dogs along the river walk. In the second survey almost all the traffic was one way in a clockwise direction which took walkers out along the road towards Kildimo, enter the river path near the old railway crossing, travel along the river and exit onto the main road at St Nicholas Church and then continue along the new footpath and back to the village.

As well as the new direction of flow there was a major increase in the amount of people walking the route.

The results of the survey are presented at the end of this report.



The road outside the goods entrance of the Dunraven Arms hotel before and after. Parked cars are no longer present and the quality and safety of the walking route has been massively improved



The four pictures below show the before and after environment. Please note that it was not possible to take a picture with people walking towards the camera in the after shots.



The four pictures above show the before and after environment. Please note that it was not possible to take a picture with people walking towards the camera in the after shots.

## Survey tables Part 2.

Thu 15-Oct-2020					
	Walkers from Village	Walkers to Village	Cars parked (Loc 1)	Cars Parked (Loc 2)	Walkers from Cars
09:00	2	52	0	0	0
10:00	1	41	0	0	0
11:00	2	36	0	0	0
12:00	1	39	0	0	0
13:00	3	28	0	0	0
14:00	4	32	0	0	0
15:00	2	36	0	0	0
16:00	1	43	0	0	0
17:00	1	40	0	0	0

Average/Hour 39

Fri 16-Oct-2020					
	Walkers from Village	Walkers to Village	Cars parked (Loc 1)	Cars Parked	Walkers from Cars
09:00	2	45	0	0	0
10:00	3	49	0	0	0
11:00	1	38	0	0	0
12:00	4	43	0	0	0
13:00	1	37	0	0	0
14:00	3	33	0	0	0
15:00	1	41	0	0	0
16:00	1	36	0	0	0
17:00	2	52	0	0	0

Average/Hour 42

Sat 17-Oct-2020					
	Walkers from Village	Walkers to Village	Cars parked (Loc 1)	Cars Parked	Walkers from Cars
09:00	0	25	0	0	0
10:00	1	36	0	0	0
11:00	2	48	0	0	0
12:00	2	41	0	0	0
13:00	3	35	0	0	0
14:00	0	43	0	0	0
15:00	1	46	0	0	0
16:00	2	55	0	0	0
17:00	2	49	0	0	0

Average/Hour 42

**Adare Survey  
part 1**

Wednesday 5-Feb-2020				
	Walkers from Village	Cars parked (Loc 1)	Cars Parked (Loc 2)	Walkers from Cars
09:00	2	0	1	2
10:00	3	1	2	4
11:00	2	1	1	3
12:00	6	0	0	0
13:00	5	2	2	6
14:00	4	1	1	2
15:00	2	0	2	4
16:00	6	0	1	2
17:00	1	0	1	1

Thursday 6-Feb-2020				
	Walkers from Village	Cars parked (Loc 1)	Cars Parked	Walkers from Cars
09:00	3	1	1	2
10:00	4	0	2	4
11:00	2	0	1	1
12:00	5	0	2	3
13:00	4	1	1	4
14:00	4	0	2	2
15:00	6	1	1	4
16:00	8	1	2	4
17:00	2	0	1	1

Friday 7-Feb-2020				
	Walkers from Village	Cars parked (Loc 1)	Cars Parked	Walkers from Cars
09:00	1	0	0	0
10:00	1	0	2	4
11:00	4	0	1	1
12:00	7	0	1	2
13:00	3	1	1	4
14:00	2	1	3	6
15:00	4	1	3	6
16:00	4	0	3	4
17:00	3	0	2	3

## **Conclusion**

The first part of the survey was done in February and there was a small but steady flow of walkers and cars parked up along the route.

We observed that all of the cars parked in location 2 (Near the entrance to the river walk) were associated with walkers.

In the second part of the survey there was a major increase in the pedestrian traffic with an average of 41 people doing the circuit every hour.

## **Observation**

The layout and signage of the river walk seems to be designed for locals and it is being very well utilised. Visitors might not be aware that by walking down the road towards Kildimo for a few hundred meters they can enter the river walk and meanwhile visitors who venture out the main road towards Limerick are met with a no entry sign if they want to enter the river walk from that side.

Survey conducted by ParkMagic survey team

Regards Paul

Paul Fitzgerald

CEO

ParkMagic Mobile solutions Ltd



**Report for October Meeting of Adare Rathkeale Municipal District**

**Restoration of Countess Dunraven Fountain, Adare**



## HISTORICAL BACKGROUND

The Countess Dunraven Fountain, as pictured below is located between the Holy Trinity Church and the Adare Heritage Centre.



As its inscription indicates, this monument was 'erected by Caroline Countess of Dunraven in grateful memory of the zeal shown by the people of this village in quenching fire at the offices Adare Manor on 1<sup>st</sup> April 1844'. The fountain therefore adds much historical and artistic interest to the town. Its site, next to the Holy Trinity Church, is a prominent one and it contributes significantly to the streetscape of the village. It was designed by Charles Hardwick who also restored the church. Fine stonemasonry and artistic skill are evident throughout the monument, with the lettering and carving to the base of the cross being particularly fine examples.

## CONDITION REPORT

The Adare Tidy Towns Development Association commissioned ACP – Architectural Conservation Professionals to prepare a structural condition report on the Countess Dunraven Statue. The report was issued to the group on 14<sup>th</sup> February 2020. The report concluded:

Generally the fountain has all the characteristics of the original fabric e.g. pointing, failing due to poor maintenance along with inappropriate repairs e.g. cementitious pointing. The hidden water pipe system within the base is no longer operational and has timber plugs hammered into the outlets which would indicate long term failure.

Overall the condition of the fountain masonry is poor and it will continue to deteriorate due to the water ingress. Repointing is only a very short term option and will not address the underlying fabric deterioration due to the water ingress. The decorative base of the cross should be monitored and inspected on a regular basis for deterioration of the crack.

The surrounding railing and landscaping is of a modern design and serious consideration should be given to restoring the surrounding steps and paved area to a more traditional Victorian style setting that is in keeping with this important historic structure.

## **TOWN AND VILLAGE RENEWAL SCHEME**

The Council issued a call for Expressions of Interest under the Accelerated Town and Village Renewal Scheme in June 2020. The Accelerated Town and Village Renewal Scheme was introduced this year and is focused on immediate responses to the COVID-19 pandemic and medium term interventions to assist rural towns and villages to recover from the impact of the virus. The maximum amount of grant funding available under the Accelerated Town and Village Scheme was €40,000.

The Adare Tidy Towns Development Association submitted an EOI to the Council on 26<sup>th</sup> June 2020 in relation to the restoration of the Countess Dunraven Statue. The proposed works outlined in the EOI are noted below:

- Dismantle and rebuild the monument to rectify the structural deficiency
- Recondition the monument façade through sand blasting and re-grouting
- Refurbish the water supply to and drain from the fountain
- Install lighting in the area
- Remove the plants, shrubbery and soil surrounding the monument
- Compact the cleared ground and pour a concrete subfloor as a base for installing limestone slabs
- Create a limestone plinth (170 m<sup>2</sup>) surrounding the monument on the cleared area
- Install stone slabs on the limestone plinth to act as seat bases
- Fix hardwood seating to the stone slabs

The EOI was selected to take forward to a full application and the Community Development Directorate worked with the group to develop the application and the final application form was submitted to the Department on the 3<sup>rd</sup> July 2020.

Grant funding of €40,000 was applied for and a cost estimate of €80,000 was noted in the application.

Match funding for the project is as follows:

€20,000 Adare Rathkeale MD GMA  
€6,225 Built Heritage Investment Scheme Grant  
€13,775 Council own resources

The Council were notified on 4<sup>th</sup> August 2020 that the grant application was successful.

Following a tender process ACP were appointed as consultants for the design and monitoring of the works as outlined in the application form.

ACP have been collaborating with the Adare Tidy Towns Development Association in developing the design for space around the fountain – one of the early concept plans for the fountain and associated space is shown below.

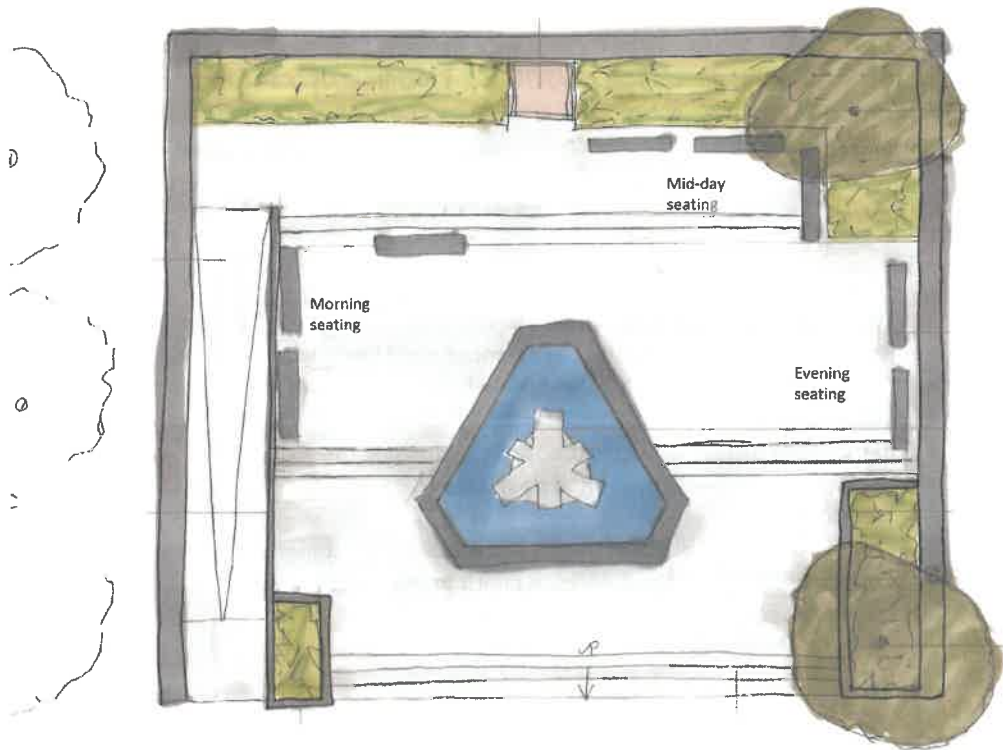

The project has now gone out to tender with an anticipated start date of December and a finish date of February 2021.

---

Gordon Daly

Director of Services,

Community Development Directorate