

**To: The Cathaoirleach and Each Member of the Municipal District of
Adare-Rathkeale**

Disposal of Land at Derry, Naintin, Rathkeale, Co. Limerick.

A chomhairleoir, a chara,

It is intended that the following proposed disposal of land will be included on the Agenda for the September Council Meeting:

Disposal of 1.40 acres of land at Derry, Naintin, Rathkeale, Co. Limerick to Mr. Michael Shiels.

The land is not required by the Council for any of its functions.

The consideration is €30,500.

Is mise le meas,



Jayne Leahy,
Head of Property Services.

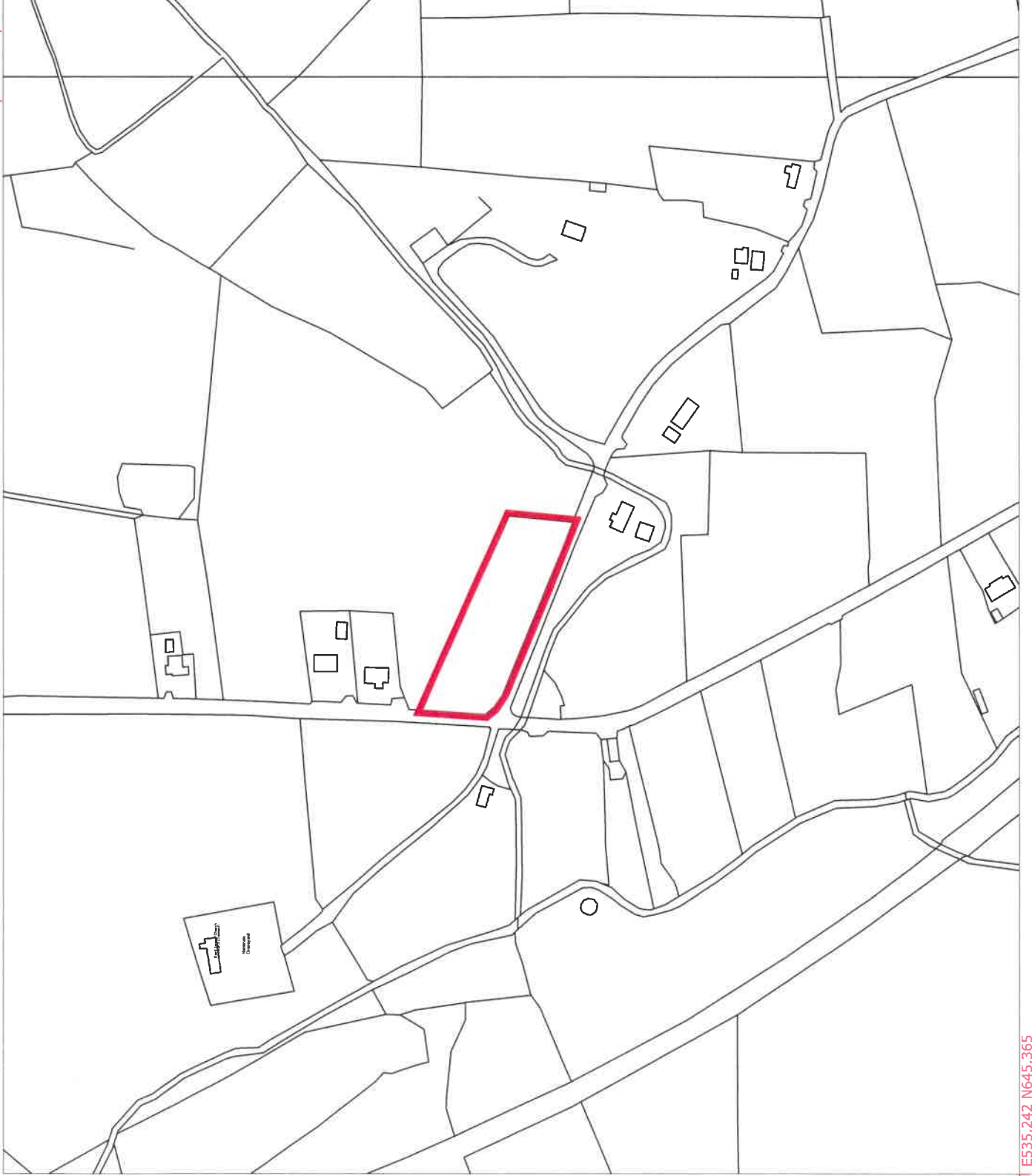

Proposed sale of site comprising of
0.58 Hectares/1.4 Acres
Site for disposal outlined in red and
located in Derrt Naintin, Rathkeale

Rev	By	Amendment	Date

Drawn by:	M. TIERNY	Area:	1.4ACRES
Scale:	1:2500	Date:	JUNE-2019
Stage:	-		

406 Disposal @ Derrt Naintin, Rathkeale, Co
Limerick

Drawing title
AG 4065



7-8 Seán Pádraig
Limerick
Limerick, Co. Limerick, N64 6000
Email: customerservice@limerick.ie Email: customerservice@limerick.ie
website: www.limerick.ie

Drawing No: **AG4065** Rev: **-**