

ISO A1 594mm x 841mm
Approved: Approver
Checked: Checker
Project Management Initials: Designer: Designer
Last Plotted: 05/02/2019 10:07:06
Filename: C:\Users\adrian.wheeler\Documents\OPRA-ACM-ZZZ-ZZ-M3-AR-0000_sdrdiag1971.rvt
Printed on 100% Post-Consumer Recycled Content Paper

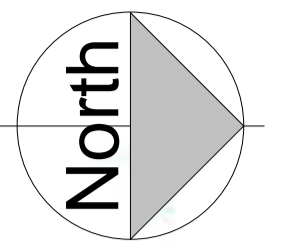

PROJECT
Opera Site

CLIENT
Limerick City and County Council

CONSULTANT
AECOM
The Clarence Street West Building
2 Clarence Street West
Belfast BT2 7GP
United Kingdom
Fax +44 (0)28 9079 5651
Tel +44 (0)28 90697200
www.aecom.com



Note: All levels referenced to Malin Head Datum

KEY PLAN

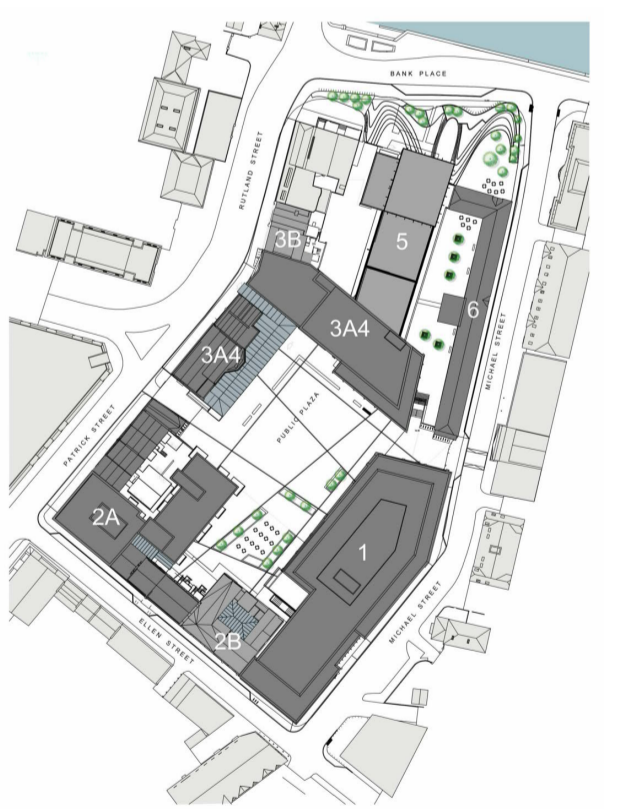

ISSUE/REVISION HISTORY

I/R	DATE	DESCRIPTION

PROJECT NUMBER

6056820

SHEET TITLE

Parcel Key Plan

SCALE

SHEET NUMBER

OPRA-ACM-ZZZ-ZZ-DR-AR-11002

REV

This drawing has been prepared for the use of AECOM's client. It may not be used, modified, reproduced or relied upon by third parties, except as agreed by AECOM or as required by law. AECOM accepts no responsibility, and denies any liability, whatsoever, to any party that uses or relies on this drawing without AECOM's express written consent. Do not scale this document. All measurements must be obtained from the stated dimensions.