



**Key**

	Existing Construction
	New Construction

**KEY PLAN**

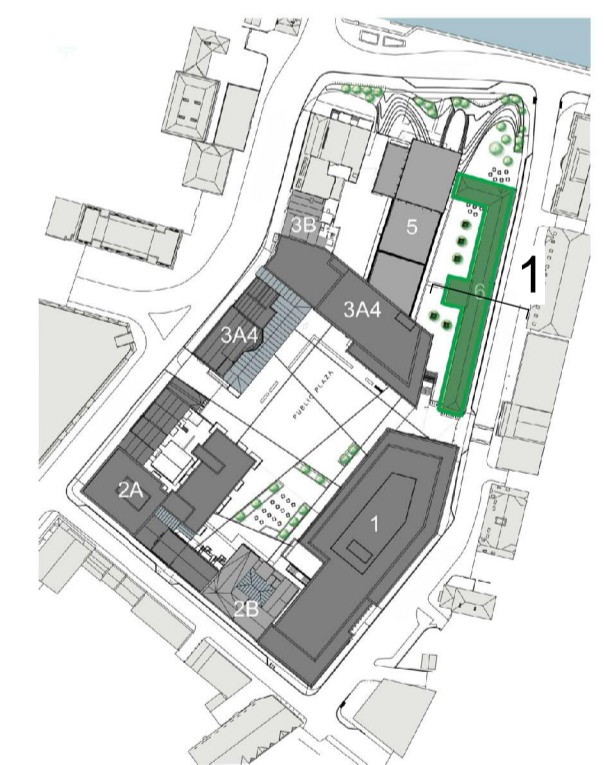

**ISSUE/REVISION HISTORY**

I/R	DATE	DESCRIPTION
-	Jan 19	Planning Submission

**PROJECT NUMBER**

60533080

**SHEET TITLE**

Parcel 6 - Proposed Section

SCALE 1 : 100 @ A1

SHEET NUMBER

OPRA-ACM-Z06-ZZ-DR-AR-12001

REV

-

The Granary, Michael Street



**1 Section 1 - Through New Stair Core (South)**  
SCALE: 1 : 100

**Schedule of Building Fabric Repair Works**

Please note, all works to historic buildings will be carried out in accordance with the Conservation Architects recommendations. Repair works to the Granary building are limited to those necessitated by the removal of the existing extension, the introduction of two new external vertical circulation cores as detailed on the drawings, and the appropriate reinstatement of archways at the internal courtyard.

Please see the Conservation Architects specifications for further information.

**Stonework**

Clean and treat stone work in accordance with Conservation Architects recommendations and allow for repointing and repairs as necessary.

**Glazing to Archways**

Re-establish historic brick arches facing onto the internal courtyard at the existing nightclub to the north of the plan, and finish with seamless structural glazing and entrance doors as necessary.

ISO A1 594mm x 841mm  
Approved - SP  
Checked - AW  
Designer - SP  
Project Management Initials - Designer - SP

Last Plotted - 12/09/2019 10:46:30  
Filename - C:\Users\Gany\Fagan\Documents\OPRA-ACM-Z06-ZZ-M3-AR-0001\_Gany\_Fagan.rvt

This drawing has been prepared for the use of AECOM's client. It may not be used, modified, reproduced or relied upon by third parties, except as agreed by AECOM or as required by law. AECOM accepts no responsibility, and denies any liability, whatsoever, to any party that uses or relies on this drawing without AECOM's express written consent. Do not scale this document. All measurements must be obtained from the stated dimensions.