

Schedule of Building Fabric Repair Works

Please note, all works to historic buildings will be carried out in accordance with the Conservation Architects recommendations. Repair works to the Granary building are limited to those necessitated by the removal of the existing extension, the introduction of two new external vertical circulation cores as detailed on the drawings, and the appropriate reinstatement of archways at the internal courtyard.

Please see the Conservation Architects specifications for further information.

Stonework

Clean and treat stone work in accordance with Conservation Architects recommendations and allow for repointing and repairs as necessary.

Glazing to Archways

Re-establish historic brick arches facing onto the internal courtyard at the existing rightlob to the north of the plan, and finish with seamless structural glazing and entrance doors as necessary.



1 Proposed Courtyard Elevation (South 01)
SCALE: 1: 100



2 Proposed Courtyard Elevation (South 02)
SCALE: 1: 100



3 Proposed Courtyard Elevation (West)
SCALE: 1: 100

Note: All levels referenced to Malin Head Datum

KEY PLAN

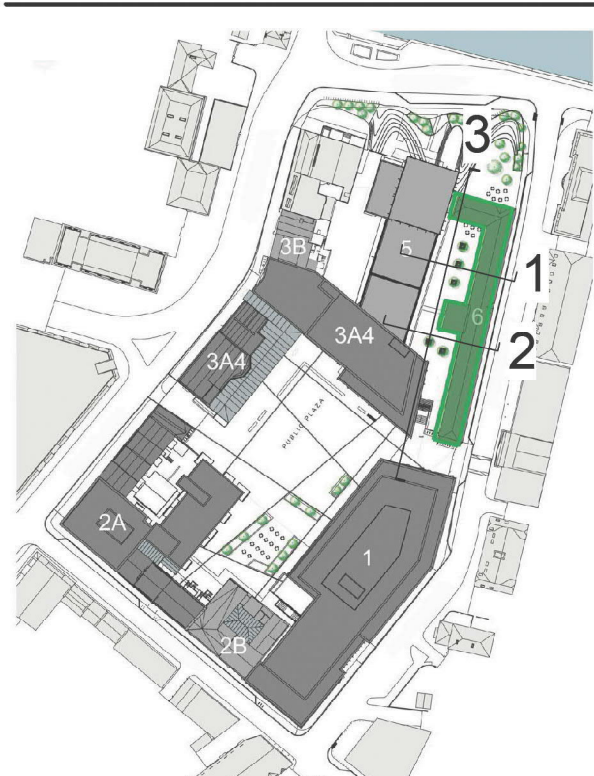

ISSUE/REVISION HISTORY

IR	DATE	DESCRIPTION
1	Jan 19	Planning Submission

PROJECT NUMBER

60533080

SHEET TITLE

Parcel 6 - Proposed Elevations (Sheet 02)

SCALE

1: 100 @ A0

SHEET NUMBER

OPRA-ACM-Z06-ZZ-DR-AR-13002

REV