

All levels referenced to Malin Head Datum  
**KEY PLAN**

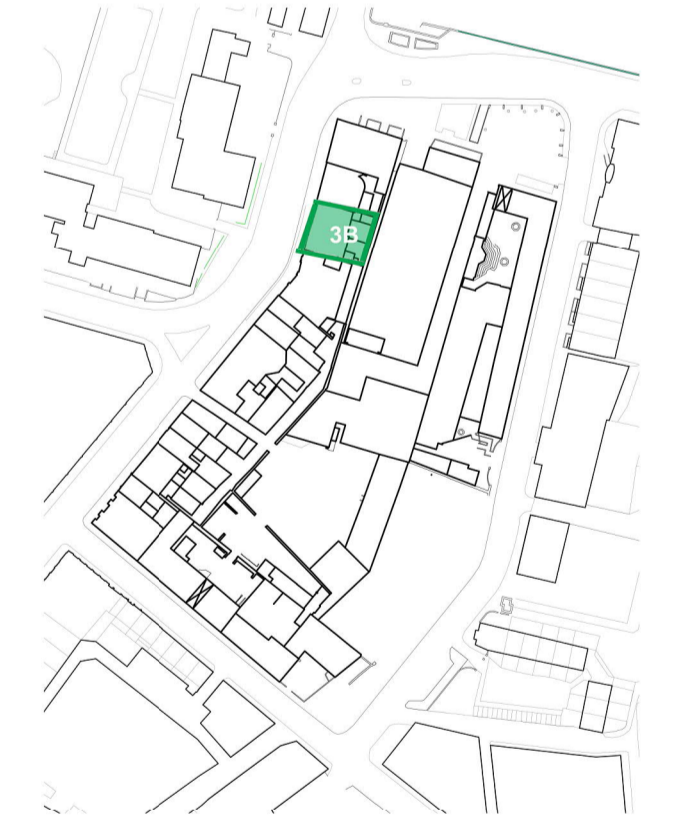

**ISSUE/REVISION HISTORY**

I/R	DATE	DESCRIPTION
-	Jan 19	Planning Submission

**PROJECT NUMBER**  
60568520

**SHEET TITLE**  
Parcel 3B - Basement & Ground Floor Demolition Plans

**SCALE** 1:100@A1

**SHEET NUMBER** OPRA-ACM-Z3B-ZZ-DR-AR-27000  
**REV** -

This drawing has been prepared for the use of AECOM's client. It may not be used, modified, reproduced or relied upon by third parties, except as agreed by AECOM or as required by law. AECOM accepts no responsibility, and denies any liability, whatsoever, to any party that uses or relies on this drawing without AECOM's express written consent. Do not scale this document. All measurements must be obtained from the stated dimensions.



**1 Demolition Basement Floor Plan**  
SCALE 1:100



**2 Demolition Ground Floor Plan**  
SCALE 1:100

**Key**

- Existing Construction
- Demolished